

PUMP PARTS CATALOGUE

Wolfking® - CFS® - GEA® - Krämer & Grebe® - Simo® - Wolfking® - CFS® - GEA® - Krämer & Grebe® - Simo®

Wolfking® - CFS® - GEA® - Krämer & Grebe® - Simo® - Wolfking® - CFS® - GEA® - Krämer & Grebe® - Simo®

Wolfking® - CFS® - GEA® - Krämer & Grebe® - Simo® - Wolfking® - CFS® - GEA® - Krämer & Grebe® - Simo®

Wolfking® - CFS® - GEA® - Krämer & Grebe® - Simo® - Wolfking® - CFS® - GEA® - Krämer & Grebe® - Simo®

Wolfking® - CFS® - GEA® - Krämer & Grebe® - Simo® - Wolfking® - CFS® - GEA® - Krämer & Grebe® - Simo®

Wolfking® - CFS® - GEA® - Krämer & Grebe® - Simo® - Wolfking® - CFS® - GEA® - Krämer & Grebe® - Simo®

Wolfking® - CFS® - GEA® - Krämer & Grebe® - Simo® - Wolfking® - CFS® - GEA® - Krämer & Grebe® - Simo®

Wolfking® - CFS® - GEA® - Krämer & Grebe® - Simo® - Wolfking® - CFS® - GEA® - Krämer & Grebe® - Simo®

Wolfking® - CFS® - GEA® - Krämer & Grebe® - Simo® - Wolfking® - CFS® - GEA® - Krämer & Grebe® - Simo®

Wolfking® - CFS® - GEA® - Krämer & Grebe® - Simo® - Wolfking® - CFS® - GEA® - Krämer & Grebe® - Simo®

Wolfking® - CFS® - GEA® - Krämer & Grebe® - Simo® - Wolfking® - CFS® - GEA® - Krämer & Grebe® - Simo®

Wolfking® - CFS® - GEA® - Krämer & Grebe® - Simo® - Wolfking® - CFS® - GEA® - Krämer & Grebe® - Simo®

Wolfking® - CFS® - GEA® - Krämer & Grebe® - Simo® - Wolfking® - CFS® - GEA® - Krämer & Grebe® - Simo®

Wolfking® - CFS® - GEA® - Krämer & Grebe® - Simo® - Wolfking® - CFS® - GEA® - Krämer & Grebe® - Simo®

Wolfking® - CFS® - GEA® - Krämer & Grebe® - Simo® - Wolfking® - CFS® - GEA® - Krämer & Grebe® - Simo®

Wolfking® - CFS® - GEA® - Krämer & Grebe® - Simo® - Wolfking® - CFS® - GEA® - Krämer & Grebe® - Simo®

Wolfking® - CFS® - GEA® - Krämer & Grebe® - Simo® - Wolfking® - CFS® - GEA® - Krämer & Grebe® - Simo®

Wolfking® - CFS® - GEA® - Krämer & Grebe® - Simo® - Wolfking® - CFS® - GEA® - Krämer & Grebe® - Simo®

Wolfking® - CFS® - GEA® - Krämer & Grebe® - Simo® - Wolfking® - CFS® - GEA® - Krämer & Grebe® - Simo®

Wolfking® - CFS® - GEA® - Krämer & Grebe® - Simo® - Wolfking® - CFS® - GEA® - Krämer & Grebe® - Simo®

Wolfking® - CFS® - GEA® - Krämer & Grebe® - Simo® - Wolfking® - CFS® - GEA® - Krämer & Grebe® - Simo®

Wolfking® - CFS® - GEA® - Krämer & Grebe® - Simo® - Wolfking® - CFS® - GEA® - Krämer & Grebe® - Simo®

Wolfking® - CFS® - GEA® - Krämer & Grebe® - Simo® - Wolfking® - CFS® - GEA® - Krämer & Grebe® - Simo®

Wolfking® - CFS® - GEA® - Krämer & Grebe® - Simo® - Wolfking® - CFS® - GEA® - Krämer & Grebe® - Simo®

Wolfking® - CFS® - GEA® - Krämer & Grebe® - Simo® - Wolfking® - CFS® - GEA® - Krämer & Grebe® - Simo®

Wolfking® - CFS® - GEA® - Krämer & Grebe® - Simo® - Wolfking® - CFS® - GEA® - Krämer & Grebe® - Simo®

Wolfking® - CFS® - GEA® - Krämer & Grebe® - Simo® - Wolfking® - CFS® - GEA® - Krämer & Grebe® - Simo®

Wolfking® - CFS® - GEA® - Krämer & Grebe® - Simo® - Wolfking® - CFS® - GEA® - Krämer & Grebe® - Simo®

Wolfking® - CFS® - GEA® - Krämer & Grebe® - Simo® - Wolfking® - CFS® - GEA® - Krämer & Grebe® - Simo®

Wolfking® - CFS® - GEA® - Krämer & Grebe® - Simo® - Wolfking® - CFS® - GEA® - Krämer & Grebe® - Simo®

Wolfking® - CFS® - GEA® - Krämer & Grebe® - Simo® - Wolfking® - CFS® - GEA® - Krämer & Grebe® - Simo®

Wolfking® - CFS® - GEA® - Krämer & Grebe® - Simo® - Wolfking® - CFS® - GEA® - Krämer & Grebe® - Simo®

Wolfking® - CFS® - GEA® - Krämer & Grebe® - Simo® - Wolfking® - CFS® - GEA® - Krämer & Grebe® - Simo®

Wolfking® - CFS® - GEA® - Krämer & Grebe® - Simo® - Wolfking® - CFS® - GEA® - Krämer & Grebe® - Simo®

Wolfking® - CFS® - GEA® - Krämer & Grebe® - Simo® - Wolfking® - CFS® - GEA® - Krämer & Grebe® - Simo®

Wolfking® - CFS® - GEA® - Krämer & Grebe® - Simo® - Wolfking® - CFS® - GEA® - Krämer & Grebe® - Simo®

Wolfking® - CFS® - GEA® - Krämer & Grebe® - Simo® - Wolfking® - CFS® - GEA® - Krämer & Grebe® - Simo®

Wolfking® - CFS® - GEA® - Krämer & Grebe® - Simo® - Wolfking® - CFS® - GEA® - Krämer & Grebe® - Simo®

Wolfking® - CFS® - GEA® - Krämer & Grebe® - Simo® - Wolfking® - CFS® - GEA® - Krämer & Grebe® - Simo®

Wolfking® - CFS® - GEA® - Krämer & Grebe® - Simo® - Wolfking® - CFS® - GEA® - Krämer & Grebe® - Simo®

Wolfking® - CFS® - GEA® - Krämer & Grebe® - Simo® - Wolfking® - CFS® - GEA® - Krämer & Grebe® - Simo®

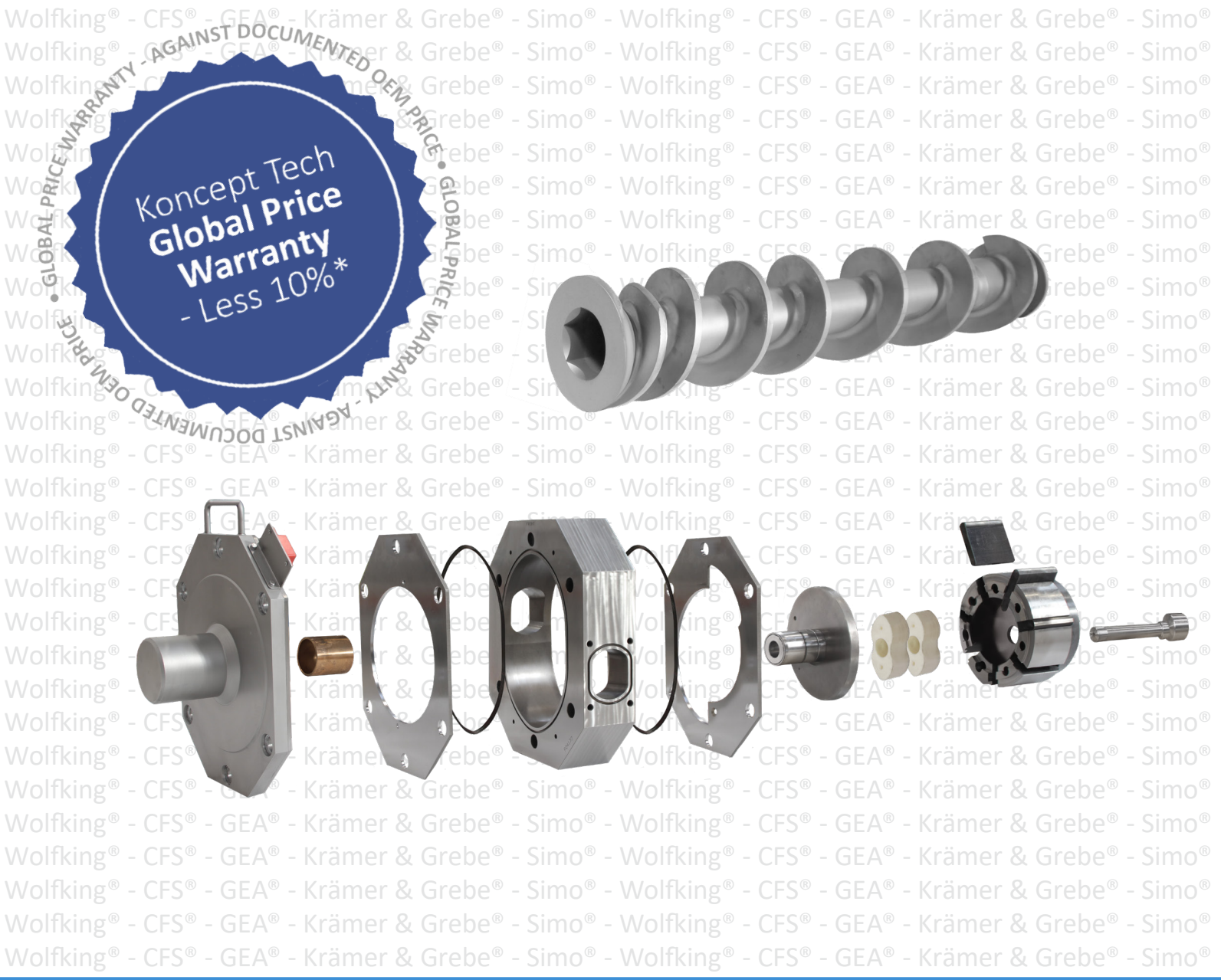

www.koncepttech.com

Koncept Tech ApS, Industrivej 6, DK-4200 Slagelse, Denmark, Phone: +45 70271410 E-mail: parts@koncepttech.com

All items, parts, and accessories listed on the website of Koncept Tech ApS, are manufactured by Koncept Tech ApS, or manufactured to Koncept Tech ApS, specifications. The names of the original equipment manufacturers referred to on this site, such as but not limited to: Camitech®, Handmann®, K&G®, Krämer + Grebe®, CFS®, GEA®, Karl Schnell®, KS®, Laska®, Palmia®, Petsmo®, Seydelmann®, Simo®, Haarslev®, Weiler®, Mincemaster®, ANCO®, Cozzini®, The Middleby Corporation®, Wolkling®, Comvair®, Auto®, Beehive®, Yeldmaster®, Meatmaker®, Poss®, Townsend®, Lima®, etc., are all registered trademarks of their respective companies. All original equipment manufacturer's names are listed as Camitech® type, Handmann® type, K&G® type, Krämer + Grebe® type, CFS® type, Karl Schnell® type, KS® type, Laska® type, Palmia® type, Petsmo® type, Seydelmann® type, Simo® type, Haarslev® type, Weiler® type, Mincemaster® type, ANCO® type, Cozzini® type, Wolkling® type, Comvair® type, Auto® type, Beehive® type, Yeldmaster® type, Meatmaker® type, Poss® type, Townsend® type, Lima® type to indicate that these items are manufactured by Koncept Tech ApS, and not the original equipment manufacturers. Unless specifically stated otherwise, Koncept Tech ApS, has no association or affiliation with any entities/ companies listed.



Follow us on LinkedIn



Follow us on Facebook

Global Price Warranty - Against documented OEM price

Wolfking® – CFS® – GEA® – Krämer & Grebe® – Simo® – Cozzini®

Koncept Tech ApS maintains a global price warranty against documented OEM price (Original Equipment Manufacturer). If, for any, reason our customer can document that the OEM price is cheaper than the quoted price from Koncept Tech, Koncept Tech shall match the documented price PLUS deduct further 10% from the said part price. All prices are quoted Ex works our factory in Denmark. Koncept Tech ApS may reserve the right to sell and deliver 1 (one) part of each part, or set, for parts covered by price warranty per customer.

This price warranty is valid for ALL parts listed in Koncept Tech High Value Parts catalogue, latest version/edition. Please find Koncept Tech Tech High Value Parts catalogue.



www.koncepttech.com

Koncept Tech ApS, Industrivej 6, DK-4200 Slagelse, Denmark, Phone: +45 70271410 E-mail: parts@koncepttech.com

All items, parts, and accessories listed on the website of Koncept Tech ApS, are manufactured by Koncept Tech ApS, or manufactured to Koncept Tech ApS, specifications. The names of the original equipment manufacturers referred to on this site, such as but not limited to: Camitech®, Handtmann®, K&G®, Krämer + Grebe®, CFS®, GEA®, Karl Schnell®, KS®, Laska®, Palmia®, Petsmo®, Seydelmann®, Simo®, Haarslev®, Weiler®, Mincemaster®, ANCO®, Cozzini®, The Middleby Corporation®, Wolfking®, Comvair®, Auto®, Beehive®, Yeldmaster®, Meatmaker®, Poss®, Townsend®, Lima® etc., are all registered trademarks of their respective companies. All original equipment manufacturer's names are listed as Camitech® type, Handtmann® type, K&G® type, Krämer + Grebe® type, CFS® type, Karl Schnell® type, KS® type, Laska® type, Palmia® type, Petsmo® type, Seydelmann® type, Simo® type, Haarslev® type, Weiler® type, Mincemaster® type, ANCO® type, Cozzini® type, Wolfking® type, Comvair® type, Auto® type, Beehive® type, Yeldmaster® type, Meatmaker® type, Poss® type, Townsend® type, Lima® type to indicate that these items are manufactured by Koncept Tech ApS, and not the original equipment manufacturers. Unless specifically stated otherwise, Koncept Tech ApS, has no association or affiliation with any entities/ companies listed.



Follow us on LinkedIn



Follow us on Facebook

List of Contents

Pump Parts:

Simo® 290.....	4-7
Simo® 250.....	8-11
Simo® 200.....	12-15
Simo® parts.....	16-18
CFD unit.....	19-20
Contiflow Pump.....	21-26
CAP 12 Pump.....	27
Cozzini® Pumps.....	28-31



Follow us on LinkedIn



Follow us on Facebook

Spare & Wear Parts for: Simo® Pump, Type 290

Pos. No.	Description
	Simo pump, type 290 (please find sketch on page 6-7)
1	Pump lining
2	Pump housing
3	Front cover for pump
4	Wear plate, bearing end
5	Bronze bushing
6	Nut for stay bolt
7	Axle journal
8	Impeller (1 quantity = 7 pieces)
9	Pipe system 290 heat jacket
10	Stay bolt for drive hub
11	Allen screw M16x160
12	Drive hub
13	Pin Ø8x32
14	Center cam (1 set = 2 pcs.)
14	Center cam HD pur/steel
15	Wear plate, lining end
16	Washer DIN 125A M30
17	Counter nut for lining - M30
18	Stay bolt for pump housing
19	Nut for front cover - M30
20	Switch plate (SuperPump 290)
21	Switch plate, (Superpump 290)
22	O-Ring Ø355 x Ø5
23	O-Ring Ø305 x Ø4
24	O-Ring Ø113 x Ø4,5
25	Pump worm

Simo® OEM Part Number	Recom- mended Quantity of Each Pos. No.	Time of Delivery (from Receipt of PO and Payment) Weeks	Net Unit Weight, per 1 (one) Unit kg	Packaging, Specifications			Total Weight (Net Unit(s) Weight + Packaging) kg	Alternative Koncept Tech® OEM Part Number	Alternative Simo® OEM Part Number
				Type	kg	L x W x H, mm			
0120-123	1	5-6 weeks	67	Pallet+frame	19	800 x 600 x 500	86	67-14	
0120-139H	1	Stock item*	107	Pallet+frame	19	800 x 600 x 500	126	67-19	012000000139H
0120-233	1	5-6 weeks	35	Pallet+frame	19	800 x 600 x 500	54	67-31	
0120-297H	1	Stock item*	5,9	Carton box	0	500 x 400 x 100	5,9	67-36	012000000297H
0120-267	1	Stock item*	0,9	Carton box	0	140 x 140 x 150	0,9	9003-0209	
0120-202H	1	Stock item*	0,3	Carton box	0	140 x 140 x 150	0,3	67-43	012000000202H
0120-664H	1	Stock item*	13,1	Carton box	0	315 x 315 x 315	13,1	67-46	012000000664H
0120-247H	1	Stock item*	16,8	Carton box	0	180 x 130 x 130	16,8	67-25	012000000247H
	1	5-6 weeks	0	Pallet+frame	19	800 x 600 x 500	19	67-241	
0120-236H	1	Stock item*	5,2	Carton box	0	250 x 250 x 250	5,2	67-23	012000000236H
2511-000076	7	Stock item*	0,3	Carton box	0	140 x 140 x 150	0,3	01-272	
0120-934	1	Stock item*	43	Pallet+frame	19	800 x 600 x 500	62	67-21	012000000934H
	1	Stock item*	0,3	Carton box	0	140 x 140 x 150	0,3	01-1345	
0120-145	1	Stock item*	1	Carton box	0	140 x 140 x 150	1	67-325	
0120-0145Pur	1	Stock item*	2,5	Carton box	0	140 x 140 x 150	2,5		
0120-385H	1	Stock item*	5,9	Carton box	0	500 x 400 x 100	5,9	67-37	012000000385H
	6	2-3 weeks	0,1	Carton box	0	140 x 140 x 150	0,1	01-684	
	6	Stock item*	0,1	Carton box	0	140 x 140 x 150	0,1	01-671	
0120-463	6	Stock item*	0,3	Carton box	0	140 x 140 x 150	0,3	67-22	
0120-721	6	Stock item*	1,5	Carton box	0	140 x 140 x 150	1,5	67-33	
	1	2-3 weeks	0,5	Carton box	0	140 x 140 x 150	0,5	05-880	
	1	2-3 weeks	0,5	Carton box	0	140 x 140 x 150	0,5	05-879	
	2	Stock item*	0,3	Carton box	0	140 x 140 x 150	0,3	01-3026	
	1	Stock item*	0,3	Carton box	0	140 x 140 x 150	0,3	01-2104	
	2	Stock item*	0,1	Carton box	0	140 x 140 x 150	0,1	01-2258	
0120-639	1	5-6 weeks	0	Wood crate	30	1500 x 400 x 550	30		



Follow us on LinkedIn



Follow us on Facebook

Spare & Wear Parts for: Simo® Pump, Type 290 (Cont.)

Pos. No.	Description
	Drawing D2 (please find sketch "measure points" in the sheet bottom)
4	Clamp 6"
5	Clamp 4"
	Not shown on drawing
	Pump worm
	Bronze bushing
	Inner ring 70x80x54
	Inner ring 70x80x35
	Wear ring UM 150
	Seal cap UM 150
	Gear box, including hex cut shaft
	Stay bolt for pump housing

Exploded drawing of Simo© Pump, Model Type 290

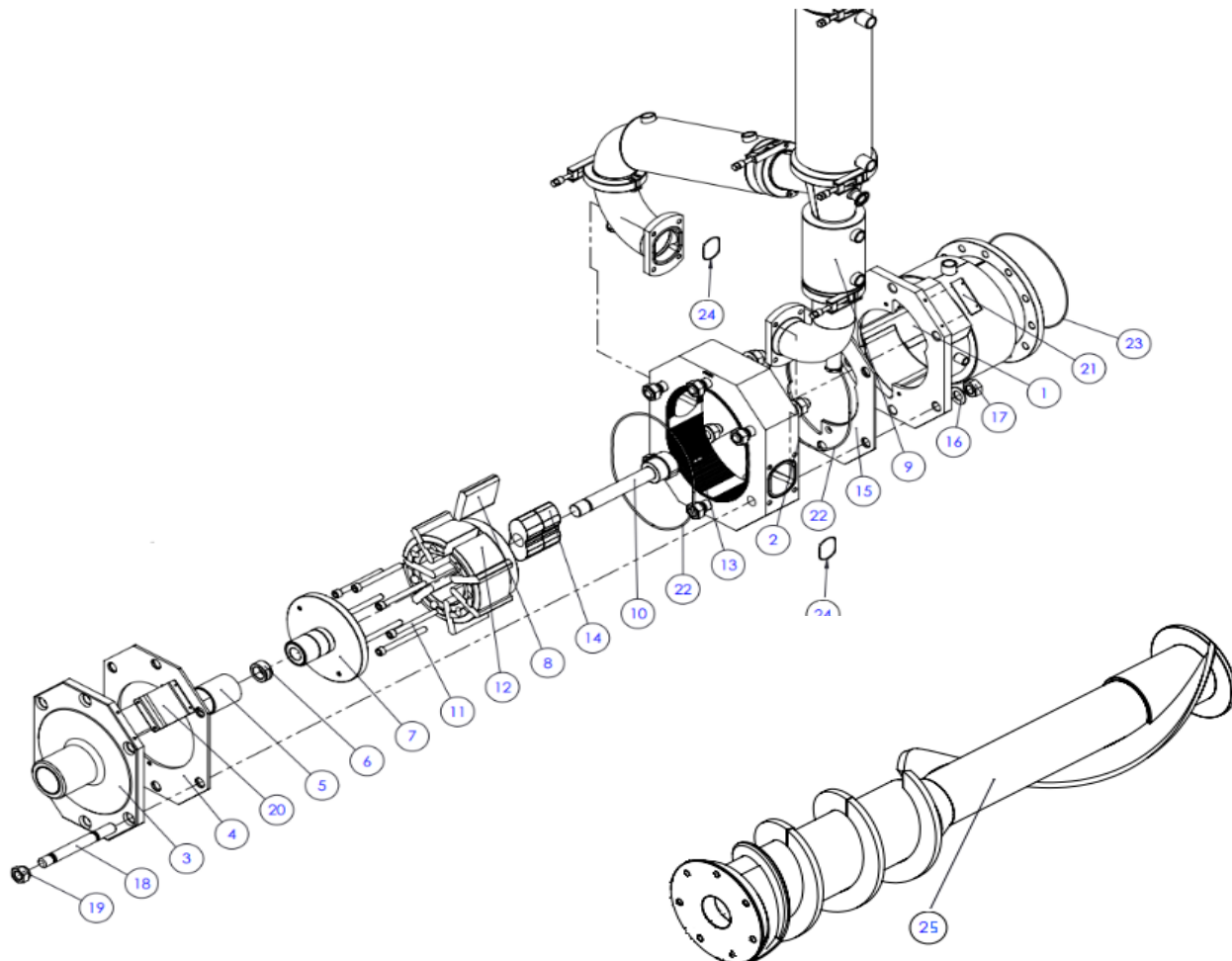

www.koncepttech.com

Koncept Tech ApS, Industrivej 6, DK-4200 Slagelse, Denmark, Phone: +45 70271410 E-mail: parts@koncepttech.com

All items, parts, and accessories listed on the website of Koncept Tech ApS, are manufactured by Koncept Tech ApS, or manufactured to Koncept Tech ApS, specifications. The names of the original equipment manufacturers referred to on this site, such as but not limited to: Camitech®, Handtmann®, K&G®, Krämer + Grebe®, CFS®, GEA®, Karl Schnell®, KS®, Laska®, Palmia®, Petsmo®, Seydelmann®, Simo®, Haarslev®, Weiler®, Mincemaster®, ANCO®, Cozzini®, The Middleby Corporation®, Wolkling®, Comvair®, Auto®, Beehive®, Yeldmaster®, Meatmaker®, Poss®, Townsend®, Lima® etc., are all registered trademarks of their respective companies. All original equipment manufacturer's names are listed as Camitech® type, Handtmann® type, K&G® type, Krämer + Grebe® type, CFS® type, Karl Schnell® type, KS® type, Laska® type, Palmia® type, Petsmo® type, Seydelmann® type, Simo® type, Haarslev® type, Weiler® type, Mincemaster® type, ANCO® type, Cozzini® type, Wolkling® type, Comvair® type, Auto® type, Beehive® type, Yeldmaster® type, Meatmaker® type, Poss® type, Townsend® type, Lima® type to indicate that these items are manufactured by Koncept Tech ApS, and not the original equipment manufacturers. Unless specifically stated otherwise, Koncept Tech ApS, has no association or affiliation with any entities/ companies listed.

Simo® OEM Part Number	Recom- mended Quantity of Each Pos. No.	Time of Delivery (from Receipt of PO and Payment) Weeks	Net Unit Weight, per 1 (one) Unit kg	Packaging, Specifications			Total Weight (Net Unit(s) Weight + Packaging) kg	Alternative Koncept Tech® OEM Part Number	Alternative Simo® OEM Part Number
				Type	kg	L x W x H, mm			
	1	3-4 weeks	4	Carton box	0	140 x 140 x 150	4	67-168	
	3	3-4 weeks	3	Carton box	0	140 x 140 x 150	3	67-152	
0120-276	1	5-6 weeks	120	Wood crate	30	1500 x 400 x 550	150		3-01-20-276
9003-0209	1	Stock item*	1	Carton box	0	139 x 140 x 150	1		5611-08090100
6173-1510	1	Stock item*	0,5	Carton box	0	140 x 140 x 150	0,5		5910-00708054
6173-1502	1	Stock item*	0,5	Carton box	0	140 x 140 x 150	0,5		
0120-75	1	Stock item*	0,5	Carton box	0	250 x 250 x 250	0,5		2511-00075-4
2511-76	1	Stock item*	0,5	Carton box	0	250 x 250 x 250	0,5		2511-00075-4
25004	1	5-6 weeks	65	Wood crate	30	1500 x 400 x 550	95		6911-72
0120-279H	6	Stock item*	0	Carton box	0	250 x 250 x 250	0		120-00000279H

Drawing of D2

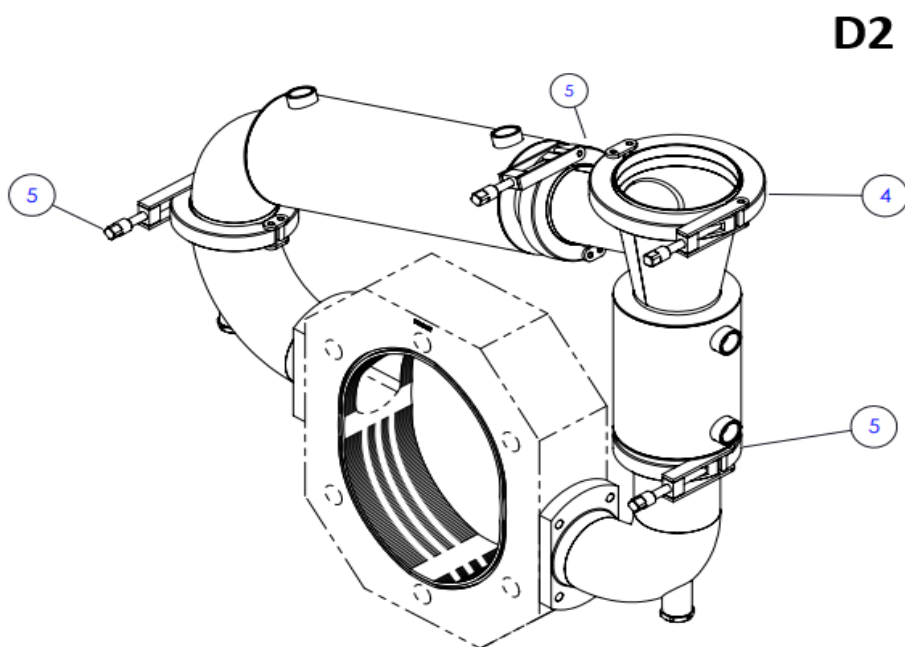

www.koncepttech.com

Koncept Tech ApS, Industrivej 6, DK-4200 Slagelse, Denmark, Phone: +45 70271410 E-mail: parts@koncepttech.com

All items, parts, and accessories listed on the website of Koncept Tech Aps, are manufactured by Koncept Tech Aps, or manufactured to Koncept Tech Aps, specifications. The names of the original equipment manufacturers referred to on this site, such as but not limited to: Camitech®, Handtmann®, K&G®, Krämer + Grebe®, CFS®, GEÄ®, Karl Schnell®, KS®, Laska®, Palmia®, Petsmo®, Seydelmann®, Simo®, Haarslev®, Weiler®, Mincemaster®, ANCO®, Cozzini®, The Middleby Corporation®, Wollking®, Cornvair®, Auto®, Beehive®, Yeldmaster®, Meatmaker®, Poss®, Townsend®, Lima® etc., are all registered trademarks of their respective companies. All original equipment manufacturer's names are listed as Camitech® type, Handtmann® type, K&G® type, Krämer + Grebe® type, CFS® type, Karl Schnell® type, KS® type, Laska® type, Palmia® type, Petsmo® type, Seydelmann® type, Simo® type, Haarslev® type, Weiler® type, Mincemaster® type, ANCO® type, Cozzini® type, Wollking® type, Cornvair® type, Auto® type, Beehive® type, Yeldmaster® type, Meatmaker® type, Poss® type, Townsend® type, Lima® type to indicate that these items are manufactured by Koncept Tech Aps, and not the original equipment manufacturers. Unless specifically stated otherwise, Koncept Tech Aps, has no association or affiliation with any entities/ companies listed.

Spare & Wear Parts for: Simo® Pump, Type 250

Pos. No.	Description
	Simo® pump, type 250 (please find sketch on page 10-11)
1	Axle journal
2	Pump lining
3	Front cover for pump
4	Stay bolt
5	Impeller (1 quantity = 7 pieces)
6	Drive hub
7	Pump system 250, heat jacket
8	Nut for stay bolt
9	Pump housing
10	Center cam
10	Center cam, HD pur/steel
11	Stay bolt for pump housing
12	Nut for front cover - M30
13	Switch plate
14	Allen Bradley safety switch
15	Counter nut for lining - M30
16	O-ring Ø1025 x Ø5
17	Wear plate, lining end
18	Wear plate, bearing end
19	O-ring Ø280 x Ø4
20	Pump Worm long
20	Pump worm
24	O-ring for pump housing Ø96 x Ø4

Simo® OEM Part Number	Recom- mended Quantity of Each Pos. No.	Time of Delivery (from Receipt of PO and Payment) Weeks	Net Unit Weight, per 1 (one) Unit kg	Packaging, Specifications			Total Weight (Net Unit(s) Weight + Packaging) kg	Alternative Koncept Tech® OEM Part Number	Alternative Simo® OEM Part Number
				Type	kg	L x W x H, mm			
0120-211H	1	Stock item*	11	Carton box	0	315 x 315 x 315	11	97-59	012000000211H
	1	5-6 weeks	45	Wood crate	30	1500 x 400 x 550	75	97-56	
0120-525	1	5-6 weeks	24	Pallet+frame	19	800 x 600 x 500	43	97-64	
0120-212H	1	Stock item*	4,9	Carton box	0	250 x 250 x 250	4,9	97-67	012000000212H
0120-199H	1	Stock item*	12,4	Carton box	0	200 x 110 x 110	12,4	97-69	012000000199H
0120-285H	1	Stock item*	24,3	Pallet+frame	19	800 x 600 x 500	43,3	97-65	012000000285H
	1	5-6 weeks	0	Pallet+frame	19	800 x 600 x 500	19	97-03	
0120-202H	1	Stock item*	1	Carton box	1	150 x 150 x 150	2		012000000202H
0120-204	1	Stock item*	36,8	Pallet+frame	19	800 x 600 x 40	55,8	97-187	
0120-101	1	Stock item*	1	Carton box	0	140 x 140 x 150	1	97-70	0120-00000101
0120-400	1	Stock item*	3	Carton box	0	140 x 140 x 150	3		
0120-268	4	Stock item*	1,1	Carton box	0	315 x 315 x 315	1,1	05-225	
0120-721	4	Stock item*	0,5	Carton box	0	140 x 140 x 150	0,5	01-671	
	1	5-6 weeks	0,5	Carton box	0	140 x 140 x 150	0,5	97-276	
	1	Stock item*	1	Carton box	0	140 x 140 x 150	1	01-267	
	4	Stock item*	0,1	Carton box	0	140 x 140 x 150	0,1	01-671	
	1	Stock item*	0,2	Carton box	0	140 x 140 x 150	0,2	01-1982	
0120-293h	1	Stock item*	3,7	Carton box	0	420 x 330 x 100	3,7	97-41	012000000293H
0120-296h	1	Stock item*	3,7	Carton box	0	420 x 330 x 100	3,7	97-63	012000000296H
	1	Stock item*	0,2	Carton box	0	140 x 140 x 150	0,2	01-1544	
0120-601	1	5-6 weeks	120	Wood crate	30	1500 x 400 x 550	150		
0120-600	1	5-6 weeks	120	Wood crate	30	1500 x 400 x 550	150	73-171	
	2	Stock item*	0,5	Carton box	0	140 x 140 x 150	0,5	01-1533	



Follow us on LinkedIn



Follow us on Facebook

Spare & Wear Parts for: Simo® Pump, Type 290 (Cont.)

Pos. No.	Description
	Drawing D2 (please find sketch "measure points" in the sheet bottom)
	Drawing D2
3	Clamp 3"
7	Clamp 4"
	Not shown on drawing:
	Allen screw
	Wear ring
	Seal cap UM 100
	Bronze bushing
	Gear box, hex shaft included

Exploded drawing of Simo® Pump, Model Type 250

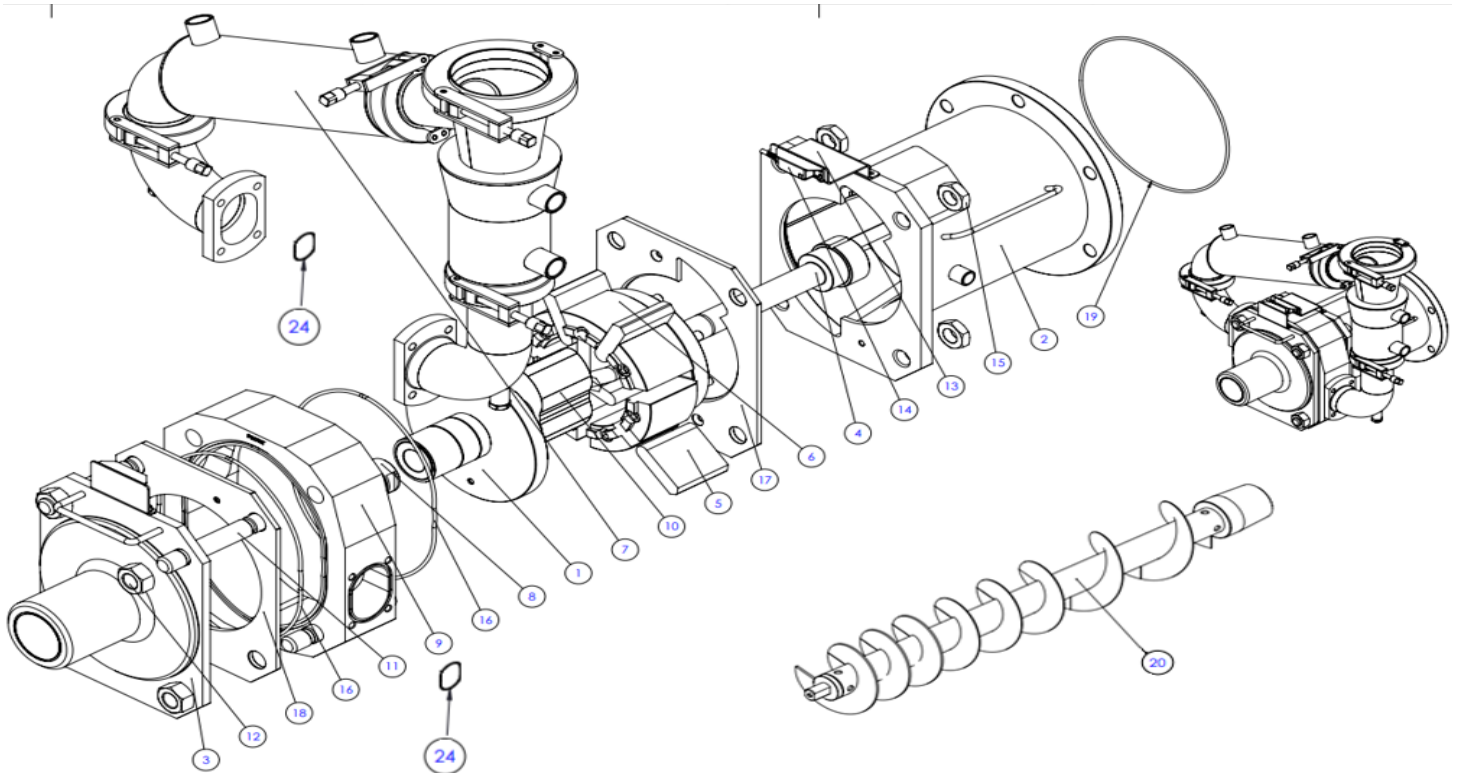

www.koncepttech.com

Koncept Tech ApS, Industrivej 6, DK-4200 Slagelse, Denmark, Phone: +45 70271410 E-mail: parts@koncepttech.com

All items, parts, and accessories listed on the website of Koncept Tech ApS, are manufactured by Koncept Tech ApS, or manufactured to Koncept Tech ApS, specifications. The names of the original equipment manufacturers referred to on this site, such as but not limited to: Camitech®, Handtmann®, K&G®, Krämer + Grebe®, CFS®, GEA®, Karl Schnell®, KS®, Laska®, Palmia®, Petsmo®, Seydelmann®, Simo®, Haarslev®, Weiler®, Mincemaster®, ANCO®, Cozzini®, The Middleby Corporation®, Wolkling®, Comvair®, Auto®, Beehive®, Yeldmaster®, Meatmaker®, Poss®, Townsend®, Lima® etc., are all registered trademarks of their respective companies. All original equipment manufacturer's names are listed as Camitech® type, Handtmann® type, K&G® type, Krämer + Grebe® type, CFS® type, Karl Schnell® type, KS® type, Laska® type, Palmia® type, Petsmo® type, Seydelmann® type, Simo® type, Haarslev® type, Weiler® type, Mincemaster® type, ANCO® type, Cozzini® type, Wolkling® type, Comvair® type, Auto® type, Beehive® type, Yeldmaster® type, Meatmaker® type, Poss® type, Townsend® type, Lima® type to indicate that these items are manufactured by Koncept Tech ApS, and not the original equipment manufacturers. Unless specifically stated otherwise, Koncept Tech ApS, has no association or affiliation with any entities/ companies listed.

Simo® OEM Part Number	Recom- mended Quantity of Each Pos. No.	Time of Delivery (from Receipt of PO and Payment) Weeks	Net Unit Weight, per 1 (one) Unit kg	Packaging, Specifications			Total Weight (Net Unit(s) Weight + Packaging) kg	Alternative Koncept Tech® OEM Part Number	Alternative Simo® OEM Part Number
				Type	kg	L x W x H, mm			
	3	Stock item*	3	Carton box	0	140 x 140 x 150	3	97-26	
	1	Stock item*	3	Carton box	0	140 x 140 x 150	3	67-152	
16x160	7	Stock item*	0,2	Carton box	0	1200 x 350 x 450	0,2	xallenm16x160	
2511-36	1	Stock item*	0,3	Carton box	0	240 x 240 x 240	0,3		2511-00036
2511-34	1	Stock item*	0,3	Carton box	0	140 x 140 x 150	0,3		2511-000034
9003-0209	1	Stock item*	0,9	Carton box	0	1200 x 350 x 450	0,9	9003-0209	
25001	1	5-6 weeks	35	Pallet+frame	18	800 x 600 x 50	53		6911-79

Drawing of D2

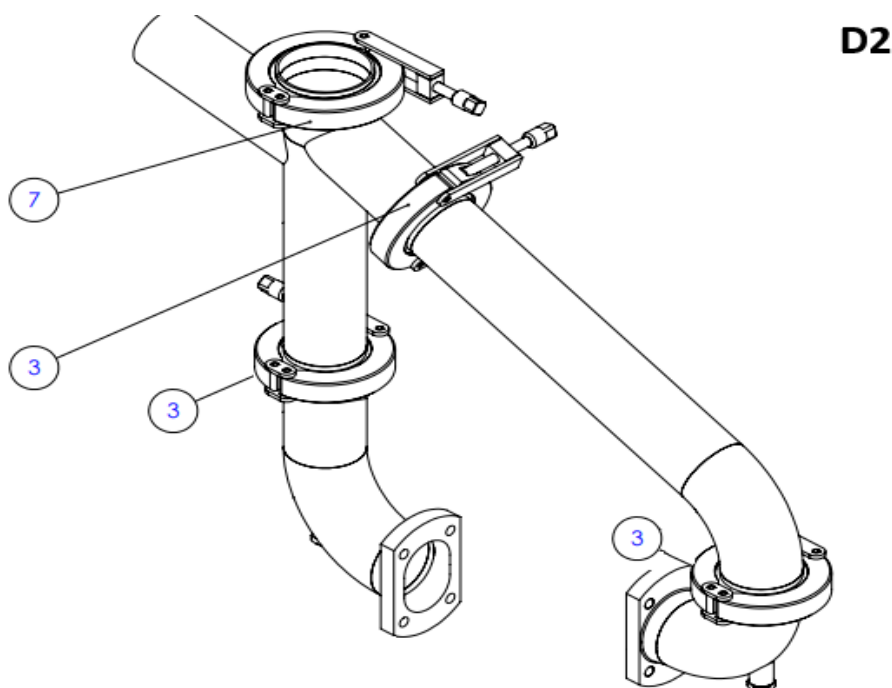

www.koncepttech.com

Koncept Tech ApS, Industrivej 6, DK-4200 Slagelse, Denmark, Phone: +45 70271410 E-mail: parts@koncepttech.com

All items, parts, and accessories listed on the website of Koncept Tech ApS, are manufactured by Koncept Tech ApS, or manufactured to Koncept Tech ApS, specifications. The names of the original equipment manufacturers referred to on this site, such as but not limited to: Camitech®, Handtmann®, K&G®, Krämer + Grebe®, CFS®, GEÄ®, Karl Schnell®, KS®, Laska®, Palmia®, Petsmo®, Seydelmann®, Simo®, Haarslev®, Weiler®, Mincemaster®, ANCO®, Cozzini®, The Middleby Corporation®, Wollking®, Comvair®, Auto®, Beehive®, Yeldmaster®, Meatmaker®, Poss®, Townsend®, Lima® etc., are all registered trademarks of their respective companies. All original equipment manufacturer's names are listed as Camitech® type, Handtmann® type, K&G® type, Krämer + Grebe® type, CFS® type, Karl Schnell® type, KS® type, Laska® type, Palmia® type, Petsmo® type, Seydelmann® type, Simo® type, Haarslev® type, Weiler® type, Mincemaster® type, ANCO® type, Cozzini® type, Wollking® type, Comvair® type, Auto® type, Beehive® type, Yeldmaster® type, Meatmaker® type, Poss® type, Townsend® type, Lima® type to indicate that these items are manufactured by Koncept Tech ApS, and not the original equipment manufacturers. Unless specifically stated otherwise, Koncept Tech ApS, has no association or affiliation with any entities/ companies listed.

Spare & Wear Parts for: Simo® Pump, Type 200

Pos. No.	Description
	Simo® pump, type 200 (please find sketch on page 14-15)
1	Axle journal
2	Lining
3	Front cover for pump
4	Stay bolt
5	Impeller (1 quantity = 7 pieces)
6	Drive hub
7	Heat jacket system
8	Nut for stay bolt
9	Pump housing
10	Center cam
11	Stay bolt for pump housing
12	Nut for front cover - M30
13	Switch plate
14	Safety switch
15	Counter nut for lining - M30
16	O-ring for pump housing Ø260x5
17	Wear plate, lining end
18	Wear plate, bearing end
19	O-Ring for lining Ø
20	Clamp
24	O-Ring Ø65x3

Simo® OEM Part Number	Recom- mended Quantity of Each Pos. No.	Time of Delivery (from Receipt of PO and Payment) Weeks	Net Unit Weight, per 1 (one) Unit kg	Packaging, Specifications			Total Weight (Net Unit(s) Weight + Packaging) kg	Alternative Koncept Tech® OEM Part Number	Alternative Simo® OEM Part Number
				Type	kg	L x W x H, mm			
0120-251H	1	Stock item*	4,7	Carton box	0	315 x 315 x 315	4,7	05-641	012000000251H
0120-88	1	5-6 weeks	28	Wooden crate	18	1200 x 350 x 450	46		0120-00000088
200-100-202	1	5-6 weeks	0	Pallet+frame	19	800 x 600 x 50			
0120-087H	1	Stock item*	2,7	Carton box	0	250 x 250 x 250	2,7		012000000087H
0120-75H	1	Stock item*	11	Carton box	0	200 x 110 x 110	11		012000000075H
0120-289	1	Stock item*	13	Pallet+frame	19	800 x 600 x 40	31	05-226	0120-00000289H
		Upon request							
0120-463	1	Stock item*	0,2	Carton box	0	140 x 140 x 150	0,2		
0120-71	1	Stock item*	23,7	Pallet+frame	19	800 x 600 x 40	42,7		
0120-76	1	Stock item*	0,4	Carton box	0	140 x 140 x 150	0,4		
0120-268	4	Stock item*	0	Carton box	0	315 x 315 x 315	0		
0120-721	4	Stock item*	0,5	Carton box	0	150 x 150 x 150	0,5	01-1671	
	1	Not available							
	1	Upon request							
	4	Stock item*	0,5	Carton box	0	150 x 150 x 150	0,5	01-1608	
	1	Stock item*	0,1	Carton box	0		0,1	01-3147	
0120-292H	1	Stock item*	2,5	Carton box	0	350 x 250 x 100	2,5		012000000292H
0120-295H	1	Stock item*	2	Carton box	0	350 x 250 x 100	2		012000000295H
	1	Stock item*	0,4	Carton box	0	140 x 140 x 140	0,4		
	4	1-2 weeks		Carton box		140 x 140 x 140	0		
	2	Stock item*	0,1	Carton box	0	140 x 140 x 140	0,1		



Follow us on LinkedIn



Follow us on Facebook

Spare & Wear Parts for: Simo® Pump, Type 200 (Cont.)

Pos. No.	Description
	Drawing D2 (please find sketch "measure points" in the sheet bottom)
1	Pump worm
1	Pump worm
	Not shown on drawing
	Allen screw
	Bronze bushing front bearing
	Inner ring 60x68x44
	Sealing ring UM 100/120x12
	Wear ring UM 100
	Seal cap UM 100
	Gear box incl. shaft

Exploded drawing of Simo® Pump, Model Type 250

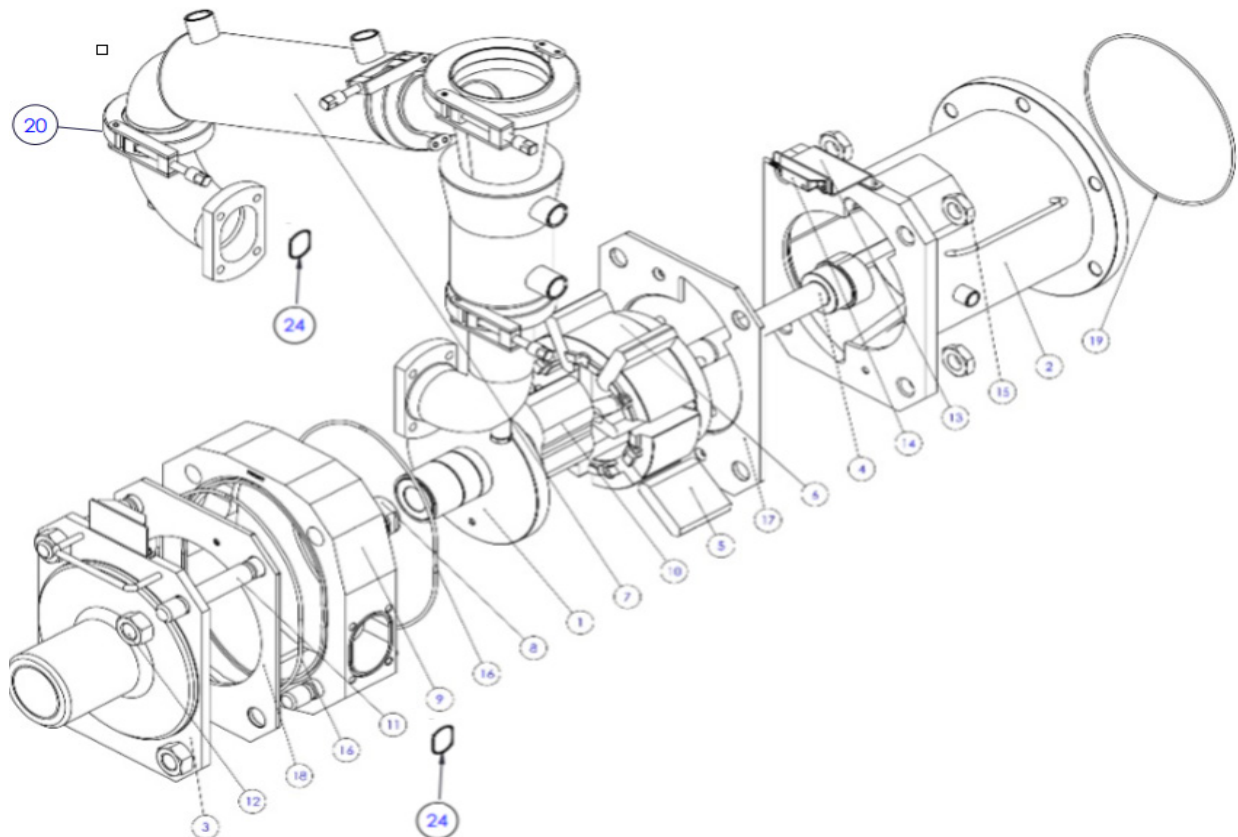

www.koncepttech.com

Koncept Tech ApS, Industrivej 6, DK-4200 Slagelse, Denmark, Phone: +45 70271410 E-mail: parts@koncepttech.com

All items, parts, and accessories listed on the website of Koncept Tech ApS, are manufactured by Koncept Tech ApS, or manufactured to Koncept Tech ApS, specifications. The names of the original equipment manufacturers referred to on this site, such as but not limited to: Camitech®, Handtmann®, K&G®, Krämer + Grebe®, CFS®, GE4®, Karl Schnell®, KS®, Laska®, Palmia®, Petsmo®, Seydelmann®, Simo®, Haarslev®, Weiler®, Mincemaster®, ANCO®, Cozzini®, The Middleby Corporation®, Wolkling®, Comvair®, Auto®, Beehive®, Yeldmaster®, Meatmaker®, Poss®, Townsend®, Lima® etc., are all registered trademarks of their respective companies. All original equipment manufacturer's names are listed as Camitech® type, Handtmann® type, K&G® type, Krämer + Grebe® type, CFS® type, Karl Schnell® type, KS® type, Laska® type, Palmia® type, Petsmo® type, Seydelmann® type, Simo® type, Haarslev® type, Weiler® type, Mincemaster® type, ANCO® type, Cozzini® type, Wolkling® type, Comvair® type, Auto® type, Beehive® type, Yeldmaster® type, Meatmaker® type, Poss® type, Townsend® type, Lima® type to indicate that these items are manufactured by Koncept Tech ApS, and not the original equipment manufacturers. Unless specifically stated otherwise, Koncept Tech ApS, has no association or affiliation with any entities/ companies listed.

Simo® OEM Part Number	Recom- mended Quantity of Each Pos. No.	Time of Delivery (from Receipt of PO and Payment) Weeks	Net Unit Weight, per 1 (one) Unit kg	Packaging, Specifications			Total Weight (Net Unit(s) Weight + Packaging) kg	Alternative Koncept Tech® OEM Part Number	Alternative Simo® OEM Part Number
				Type	kg	L x W x H, mm			
0120-77	1	Stock item*	50	Pallet+frame	19	800 x 600 x 40	69		0120-000000777
0120-649	1	5-6 weeks	50	Wooden box	18	1200 x 350 x 450	68		
16x130	7	Stock item*	0,1	Carton box	0	140 x 140 x 150	0,1	otmm901-xm16x130	
0120-266	1	Stock item*	1	Carton box	0	140 x 140 x 140	1		0120-00000266
6173-1379	1	Stock item*	1	Carton box	0	140 x 140 x 140	1		6173-1379
6312-6	1	Stock item*	1	Carton box	0	140 x 140 x 140	1		6312-000006
2511-36	1	Stock item*	1	Carton box	0	140 x 140 x 150	1		2511-000036
2511-34	1	Stock item*	0,3	Carton box	0	140 x 140 x 150	0,3		2511-000034
6911-79	1	5-6 weeks	35	Wooden box	18	1200 x 350 x 450	53		6911-79

Drawing of D2

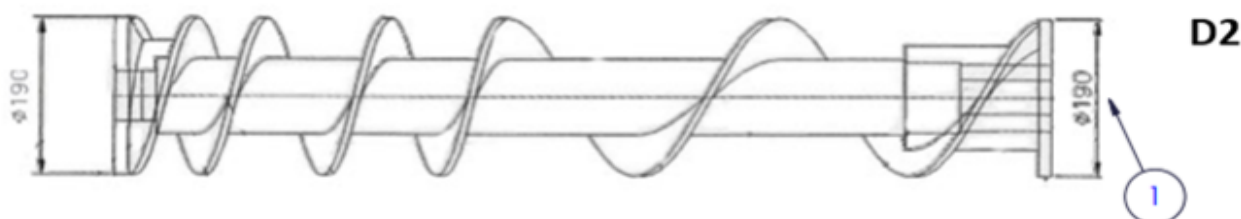

Wolfgang® / CFS® / GEA® / Simo® Pump Parts

Simo® Type Pumps Model 200, 250, 290

Description	Part Number DC 200	Part Number DC 250	Part Number DC 290
Drive hub	0120-89	0120-285	0120-934
Stay bolt	0120-87H	0120-212H	0120-236H
Nut for stay bolt	0120-463	0120-202H	0120-202H
Impeller (1 set = 7 pcs.)	0120-75H	0120-199H	0120-247H
Wear plate, lining end	0120-292H	0120-293H	0120-385H
Wear plate, bearing end	0120-295H	0120-296H	0120-297H
Center cam	0120-76	0120-101	0120-145
Center cam HD pur/steel	N/A	N/A	0120-0145Pur
Allen screw	otmm901-xm16x130	xallenm16x160	290xUnbraco16x200
Bronze bushing 80/90x100	N/A	9003-0209	9003-0209
Pump housing	0120-71	0120-204	0120-139H
Axle journal	0120-251H	0120-211H	0120-664H
Pump worm	0120-649	0120-600	0120-639
Gear	ED2065	25001	25004
Seal cap f/UM sealing	N/A	N/A	2511-000076
Stay bolt f/pump housing	0120-268	0120-268	0120-279

HD = Heavy Duty



Pump housings 200, 250, and 290,
part number 0120-71 , 0120-204 , 0120-139H



www.koncepttech.com

Koncept Tech ApS, Industrivej 6, DK-4200 Slagelse, Denmark, Phone: +45 70271410 E-mail: parts@koncepttech.com







All items, parts, and accessories listed on the website of Koncept Tech ApS, are manufactured by Koncept Tech ApS, or manufactured to Koncept Tech ApS, specifications. The names of the original equipment manufacturers referred to on this site, such as but not limited to: Camitech®, Handtmann®, K&G®, Krämer + Grebe®, CFS®, GEA®, Karl Schnell®, KS®, Laska®, Palmia®, Petsmo®, Seydelmann®, Simo®, Haarslev®, Weiler®, Mincemaster®, ANCO®, Cozzini®, The Middleby Corporation®, Wolfgang®, Comvair®, Auto®, Beehive®, Yeldmaster®, Meatmaker®, Poss®, Townsend®, Lima® etc., are all registered trademarks of their respective companies. All original equipment manufacturer's names are listed as Camitech® type, Handtmann® type, K&G® type, Krämer + Grebe® type, CFS® type, Karl Schnell® type, KS® type, Laska® type, Palmia® type, Petsmo® type, Seydelmann® type, Simo® type, Haarslev® type, Weiler® type, Mincemaster® type, ANCO® type, Cozzini® type, Wolfgang® type, Comvair® type, Auto® type, Beehive® type, Yeldmaster® type, Meatmaker® type, Poss® type, Townsend® type, Lima® type to indicate that these items are manufactured by Koncept Tech ApS, and not the original equipment manufacturers. Unless specifically stated otherwise, Koncept Tech ApS, has no association or affiliation with any entities/ companies listed.

Wolfling® / CFS® / GEA® / Simo® Pump Parts (Cont.)





Pump housing,
partnumber 0120-71 , 0120-204
, 0120-139H 





Center cam for 200, 250, and 290,
partnumber 0120-76 , 0120-101 ,
0120-145 
Allen screw
part number otmm901-xm16x130 
xallenm16x160 , 290xUnbraco16x200 





Drive hub,
part number 0120-89 ,
0120-285 , 0120-934 



Impellers for 200, 250, 290 (1 set= 7 pcs.),
partnumber 0120-75H , 0120-199H ,
0120-247H 





Axle journal,
part number 0120-251H ,
0120-211H , 0120-664H





Center cam HD for 290, pur/steel
partnumber 0120-0145Pur 





Stay bolt for drive hub,
partnumber 0120-87H ,
0120-212H , 0120-236H 



Wear plate, bearing end,
partnumber 0120-295H ,
0120-296H , 0120-297H 



Wear plate, lining end,
partnumber 0120-292H ,
0120-293H , 0120-385H 



Follow us on LinkedIn



Follow us on Facebook

Wolfling® / CFS® / GEA® / Simo® Pump Parts (Cont.)



Front cover for pump, part number
0120-233 ✓



Bronze bushing 80/90x100
Part number 9003-0209 ✓



Stay bolt for pump housing,
part number 0120-268, 0120-279 ✓



Pump worm for 290 Pump,
part number 0120-639 ✓

Pump head Assembly

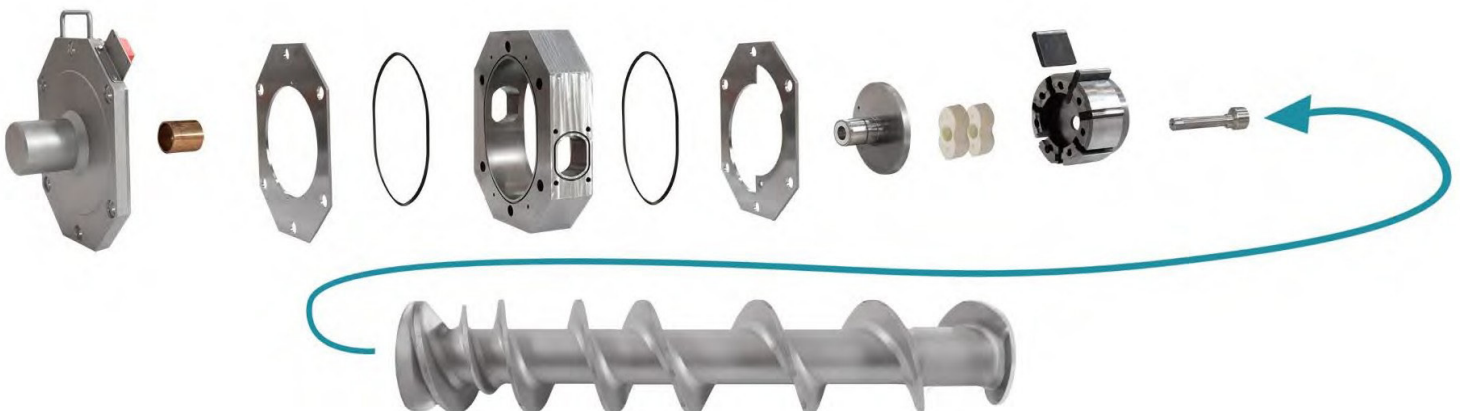

www.koncepttech.com

Koncept Tech ApS, Industrivej 6, DK-4200 Slagelse, Denmark, Phone: +45 70271410 E-mail: parts@koncepttech.com

All items, parts, and accessories listed on the website of Koncept Tech ApS, are manufactured by Koncept Tech ApS, or manufactured to Koncept Tech ApS, specifications. The names of the original equipment manufacturers referred to on this site, such as but not limited to: Camitech®, Handtmann®, K&G®, Krämer + Grebe®, CFS®, GEA®, Karl Schnell®, KS®, Laska®, Palmia®, Petsmo®, Seydelmann®, Simo®, Haarslev®, Weiler®, Mincemaster®, ANCO®, Cozzini®, The Middleby Corporation®, Wolfling®, Comvair®, Auto®, Beehive®, Yeldmaster®, Meatmaker®, Poss®, Townsend®, Lima® etc., are all registered trademarks of their respective companies. All original equipment manufacturer's names are listed as Camitech® type, Handtmann® type, K&G® type, Krämer + Grebe® type, CFS® type, Karl Schnell® type, KS® type, Laska® type, Palmia® type, Petsmo® type, Seydelmann® type, Simo® type, Haarslev® type, Weiler® type, Mincemaster® type, ANCO® type, Cozzini® type, Wolfling® type, Comvair® type, Auto® type, Beehive® type, Yeldmaster® type, Meatmaker® type, Poss® type, Townsend® type, Lima® type to indicate that these items are manufactured by Koncept Tech ApS, and not the original equipment manufacturers. Unless specifically stated otherwise, Koncept Tech ApS, has no association or affiliation with any entities/ companies listed.

Wolfking® / CFS® / GEA® Pump Parts - CFD Unit

Parts list for Wolfking®/CFS®/SIMO®/GEA® CFD MD85 - Wolfking® C.250 & Wolfking® SFG 1500/250

Position No.	Description	Part Number
1	Suction gate for Contiflow	36335/315657
2	Pressure gate for Contiflow	37134
3	Bushing (pressure gate)	30379
4	Wear ring for pressure gate	35765
5	Wear ring for suction gate	35545
6	Part for drive hub for CFD	30568
7	Worm pin	30227
8	Bushing for part of driving hub	30672/314352
9	Pump housing 16 m3	"32850/35548 317680"
10	Pallets (1 set = 2 pcs.)	38546
11	inserts for pallets (1 set = 4 pcs) - Plastic	34468/41494
10	Palette system for HD execution (1 set = 2 pcs)	37696
11	Loose inserts for pallets HD execution metal (1 set = 4 pcs.)	37697
12	Drive hub CFD II-III model 85	30569/317627
13	Bushing (Drive hub)	30673/314354
14	Thrust ring for CFD, stainless steel	30622
15	Bearing bushing for suction gate	30380
16	Axial bearing for suction gate for CFD	30381
16	Axial bearing for suction gate for CFD - NEW VERSION	314355
17	Handle for fixtures, stainless steel for CFD	30510
18	O-ring 304mm x 3mm, pressure gate	23250
19	O-ring 249,3mm x 5,7mm, pressure gate	23348

www.koncepttech.com

Koncept Tech ApS, Industrivej 6, DK-4200 Slagelse, Denmark, Phone: +45 70271410 E-mail: parts@koncepttech.com

All items, parts, and accessories listed on the website of Koncept Tech ApS, are manufactured by Koncept Tech ApS, or manufactured to Koncept Tech ApS, specifications. The names of the original equipment manufacturers referred to on this site, such as but not limited to: Camilech®, Handtmann®, K&G®, Krämer + Grebe®, CFS®, GEA®, Karl Schnell®, KS®, Laska®, Palmia®, Petsmo®, Seydelmann®, Simo®, Haarslev®, Weiler®, Mincemaster®, ANCO®, Cozzini®, The Middleby Corporation®, Wolfking®, Comvair®, Auto®, Beehive®, Yieldmaster®, Meatmaker®, Poss®, Townsend®, Lima® etc., are all registered trademarks of their respective companies. All original equipment manufacturer's names are listed as Camilech® type, Handtmann® type, K&G® type, Krämer + Grebe® type, CFS® type, Karl Schnell® type, KS® type, Laska® type, Palmia® type, Petsmo® type, Seydelmann® type, Simo® type, Haarslev® type, Weiler® type, Mincemaster® type, ANCO® type, Cozzini® type, Wolfking® type, Comvair® type, Auto® type, Beehive® type, Yieldmaster® type, Meatmaker® type, Poss® type, Townsend® type, Lima® type to indicate that these items are manufactured by Koncept Tech ApS, and not the original equipment manufacturers. Unless specifically stated otherwise, Koncept Tech ApS, has no association or affiliation with any entities/ companies listed.



Follow us on LinkedIn



Follow us on Facebook

Wolfking® / CFS® / GEA® Pump Parts - CFD Unit(Cont.)

Exploded View of Wolfking®/CFS®/SIMO®/GEA® CFD MD85 - Wolfking® C.250 & Wolfking® SFG 1500/250

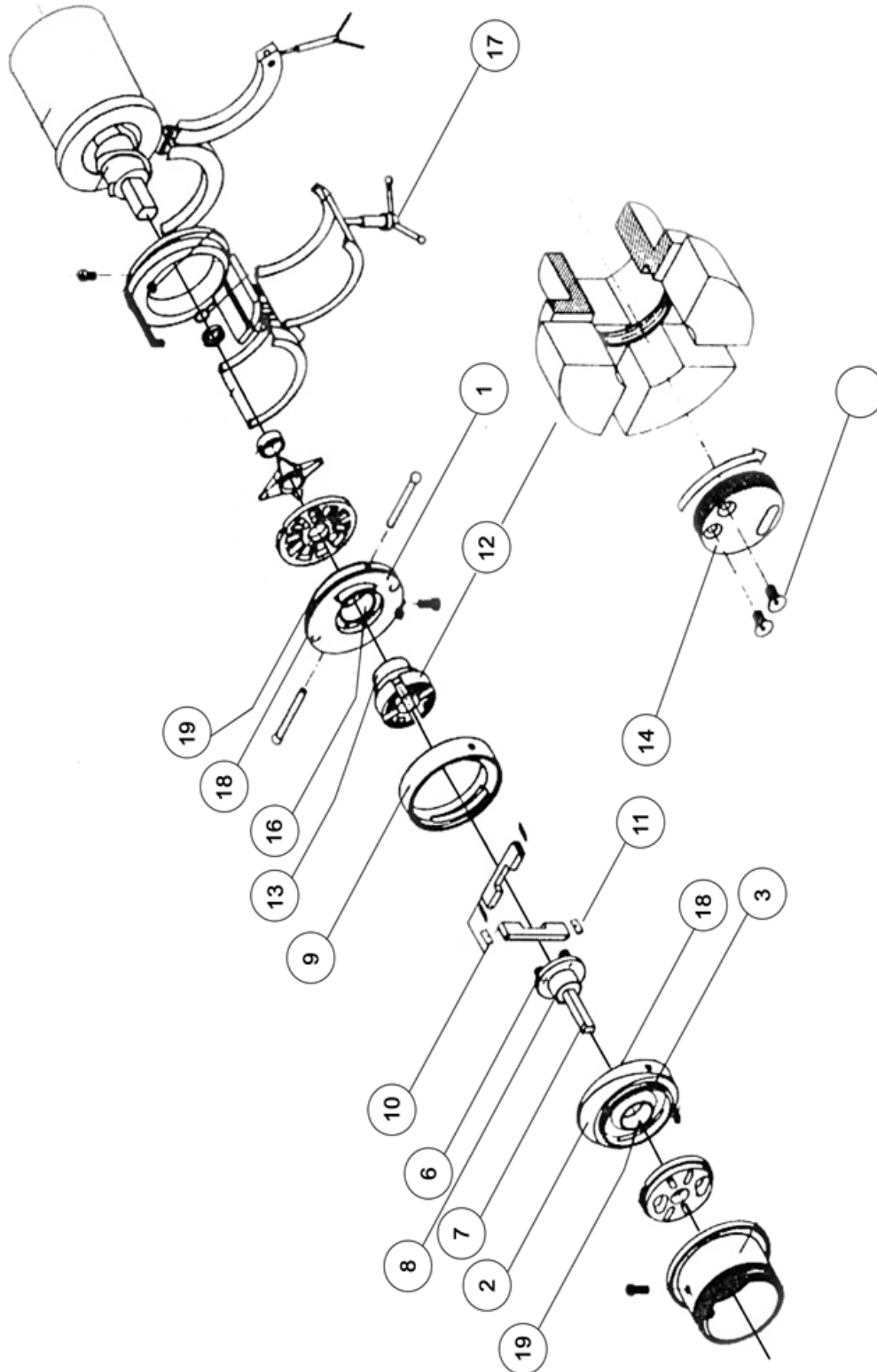

www.koncepttech.com

Koncept Tech ApS, Industrivej 6, DK-4200 Slagelse, Denmark, Phone: +45 70271410 E-mail: parts@koncepttech.com

All items, parts, and accessories listed on the website of Koncept Tech ApS, are manufactured by Koncept Tech ApS, or manufactured to Koncept Tech ApS, specifications. The names of the original equipment manufacturers referred to on this site, such as but not limited to: Camiltech®, Handtmann®, K&G®, Krämer + Grebe®, CFS®, GEA®, Karl Schnell®, KS®, Laska®, Palmia®, Petsmo®, Seydelmann®, Simo®, Haarslev®, Weiler®, Mincemaster®, ANCO®, Cozzini®, The Middleby Corporation®, Wolfking®, Comvair®, Auto®, Beehive®, Yeldmaster®, Meatmaker®, Poss®, Townsend®, Lima® etc., are all registered trademarks of their respective companies. All original equipment manufacturer's names are listed as Camiltech® type, Handtmann® type, K&G® type, Krämer + Grebe® type, CFS® type, Karl Schnell® type, KS® type, Laska® type, Palmia® type, Petsmo® type, Seydelmann® type, Simo® type, Haarslev® type, Weiler® type, Mincemaster® type, ANCO® type, Cozzini® type, Wolfking® type, Comvair® type, Auto® type, Beehive® type, Yeldmaster® type, Meatmaker® type, Poss® type, Townsend® type, Lima® type to indicate that these items are manufactured by Koncept Tech ApS, and not the original equipment manufacturers. Unless specifically stated otherwise, Koncept Tech ApS, has no association or affiliation with any entities/ companies listed.

Wolfling® / CFS® / GEA® Pump Parts - Contiflow Pump

Parts list for Wolfling®/CFS®/SIMO®/GEA® Contiflow pump

Position No.	Description	Part Number
1	Suction gate for Contiflow	36335/315657
2	Pressure gate for Contiflow	37134
3	Bushing (pressure gate)	30379
4	Wear ring for pressure gate	35765
5	Wear ring for suction gate	35545
6	Part for drive hub for CFD	35594
7	Bushing for part of driving hub	30672/314352 32850/35548
8	Pump housing 16 m3	317680
9	Pallets (1 set = 2 pcs.)	38546
10	Inserts for pallets (1 set = 4 pcs) - Plastic	34468/41494
9	Palette system for HD execution (1 set = 2 pcs)	37696
10	Loose inserts for pallets HD execution metal (1 set = 4 pcs.)	37697
11	Drive hub CFD II-III model 85	30569/317627
12	Bushing (Drive hub)	30673/314354
13	Thrust ring for CFD, stainless steel	30622
14	Bearing bushing for suction gate	30380
15	Axial bearing for suction gate for CFD	30381
15	Axial bearing for suction gate for CFD - NEW VERSION	314355
16	Outlet nozzle 4", for Contiflow	37455/320169
	Main bearing	310858
	Drive shaft for main bearing	35576
	Gear, planetary EM1045	25028



Follow us on LinkedIn



Follow us on Facebook

Wolfgang® / CFS® / GEA® Pump Parts - Contiflow Pump (Cont.)

Parts list for Wolfgang® / CFS® / GEA® Contiflow Pump (Part 3 of 3)

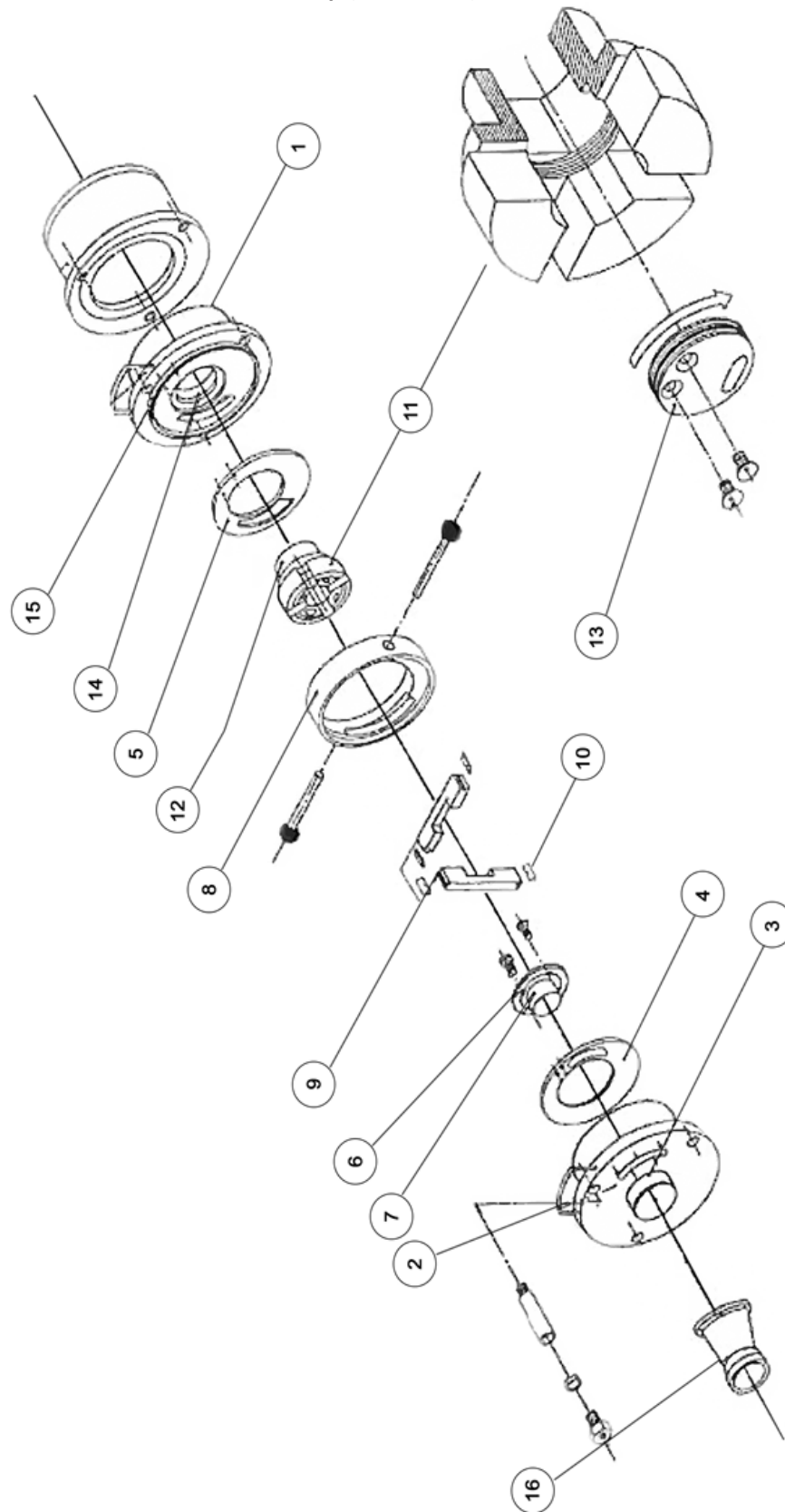

www.koncepttech.com

Koncept Tech ApS, Industrivej 6, DK-4200 Slagelse, Denmark, Phone: +45 70271410 E-mail: parts@koncepttech.com

All items, parts, and accessories listed on the website of Koncept Tech ApS, are manufactured by Koncept Tech ApS, or manufactured to Koncept Tech ApS, specifications. The names of the original equipment manufacturers referred to on this site, such as but not limited to: Camitech®, Handtmann®, K&G®, Krämer + Grebe®, CFS®, GEA®, Karl Schnell®, KS®, Laska®, Palmia®, Petsmo®, Seydelmann®, Simo®, Haarslev®, Weiler®, Mincemaster®, ANCO®, Cozzini®, The Middleby Corporation®, Wolfgang®, Comvair®, Auto®, Beehive®, Yeldmaster®, Meatmaker®, Poss®, Townsend®, Lima®, etc., are all registered trademarks of their respective companies. All original equipment manufacturer's names are listed as Camitech® type, Handtmann® type, K&G® type, Krämer + Grebe® type, CFS® type, Karl Schnell® type, KS® type, Laska® type, Palmia® type, Petsmo® type, Seydelmann® type, Simo® type, Haarslev® type, Weiler® type, Mincemaster® type, ANCO® type, Cozzini® type, Wolfgang® type, Comvair® type, Auto® type, Beehive® type, Yeldmaster® type, Meatmaker® type, Poss® type, Townsend® type, Lima® type to indicate that these items are manufactured by Koncept Tech ApS, and not the original equipment manufacturers. Unless specifically stated otherwise, Koncept Tech ApS, has no association or affiliation with any entities/ companies listed.



Follow us on LinkedIn



Follow us on Facebook

Wolfgang® / CFS® / GEA® Pump Parts - Contiflow Pump 250 & Vane Pump SF & DF



Loose insert for pallets in metal (1 set=4pcs.),
part number 5000037697 ✓/37697 ✓



Pallet
part number 5000038546 ✓/38546 ✓

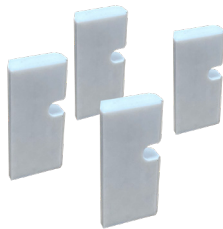

Plastic insert for pallets (set=4pcs.), part
number 5000034468 ✓/34468 ✓

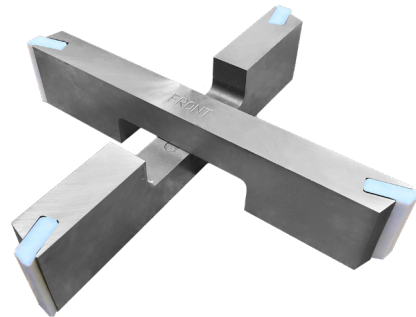

Pallets HD for Contiflow (set=2 pcs.)
part number 37696 ✓



Side plate/pressure part CFD, stainless steel



Various Contiflow 250 pump parts



Thrust ring for CFD, stainless steel
part number 5000030622/30622 ✓

HD = Heavy Duty

www.koncepttech.com

Koncept Tech ApS, Industrivej 6, DK-4200 Slagelse, Denmark, Phone: +45 70271410 E-mail: parts@koncepttech.com

All items, parts, and accessories listed on the website of Koncept Tech ApS, are manufactured by Koncept Tech ApS, or manufactured to Koncept Tech ApS, specifications. The names of the original equipment manufacturers referred to on this site, such as but not limited to: Camitech®, Handtmann®, K&G®, Krämer + Grebe®, CFS®, GEA®, Karl Schnell®, KS®, Laska®, Palmia®, Petsmo®, Seydelmann®, Simo®, Haarslev®, Weiler®, Mincemaster®, ANCO®, Cozzini®, The Middleby Corporation®, Wolfgang®, Comvair®, Auto®, Beehive®, Yeldmaster®, Meatmaker®, Poss®, Townsend®, Lima® etc., are all registered trademarks of their respective companies. All original equipment manufacturer's names are listed as Camitech® type, Handtmann® type, K&G® type, Krämer + Grebe® type, CFS® type, Karl Schnell® type, KS® type, Laska® type, Palmia® type, Petsmo® type, Seydelmann® type, Simo® type, Haarslev® type, Weiler® type, Mincemaster® type, ANCO® type, Cozzini® type, Wolfgang® type, Comvair® type, Auto® type, Beehive® type, Yeldmaster® type, Meatmaker® type, Poss® type, Townsend® type, Lima® type to indicate that these items are manufactured by Koncept Tech ApS, and not the original equipment manufacturers. Unless specifically stated otherwise, Koncept Tech ApS, has no association or affiliation with any entities/ companies listed.



Follow us on LinkedIn



Follow us on Facebook

Wolfling® / CFS® / GEA® Pump Parts - Contiflow Pump 250 & Vane Pump SF & DF (Cont.)



Bushing for part of driving hub
part number 5000030672 ✓/30672 ✓



Bushing
part number 50000314354 / 314354



Bushing for suction gate Ø130xØ120x53
part number 5000030381 ✓/30381 ✓



Bushing for pressure gate
5000030379 ✓/ 30379 ✓



Wear ring for pressure gate
part number 5000035765/35765 ✓



Wear ring for suction gate
part number 5000035545/35545 ✓

www.koncepttech.com

Koncept Tech ApS, Industrivej 6, DK-4200 Slagelse, Denmark, Phone: +45 70271410 E-mail: parts@koncepttech.com

All items, parts, and accessories listed on the website of Koncept Tech ApS, are manufactured by Koncept Tech ApS, or manufactured to Koncept Tech ApS, specifications. The names of the original equipment manufacturers referred to on this site, such as but not limited to: Camitech®, Handtmann®, K&G®, Krämer + Grebe®, CFS®, GEA®, Karl Schnell®, KS®, Laska®, Palmia®, Petsmo®, Seydelmann®, Simo®, Haarslev®, Weiler®, Mincemaster®, ANCO®, Cozzini®, The Middleby Corporation®, Wolfling®, Comvair®, Auto®, Beehive®, Yeldmaster®, Meatmaker®, Poss®, Townsend®, Lima® etc., are all registered trademarks of their respective companies. All original equipment manufacturer's names are listed as Camitech® type, Handtmann® type, K&G® type, Krämer + Grebe® type, CFS® type, Karl Schnell® type, KS® type, Laska® type, Palmia® type, Petsmo® type, Seydelmann® type, Simo® type, Haarslev® type, Weiler® type, Mincemaster® type, ANCO® type, Cozzini® type, Wolfling® type, Comvair® type, Auto® type, Beehive® type, Yeldmaster® type, Meatmaker® type, Poss® type, Townsend® type, Lima® type to indicate that these items are manufactured by Koncept Tech ApS, and not the original equipment manufacturers. Unless specifically stated otherwise, Koncept Tech ApS, has no association or affiliation with any entities/ companies listed.



Follow us on LinkedIn



Follow us on Facebook

Wolfking® / CFS® / GEA® Pump Parts - Contiflow Pump 250 & Vane Pump SF & DF (Cont.)



Rear hub for Contiflow pump – seen from the side
part number 5000030569 / 30569 , 5000317627 / 317627



Rear hub for Contiflow pump – seen from the bottom
part number 5000030569 / 30569 , 5000317627 / 317627



Wolfking®/CFS®/SIMO®/GEA® CFD MD85 - Wolfking® C.250 & Wolfking® SFG 1500/250

*Part seen below of drive hub is only compatible with the CFD type pump which is build on the grinder

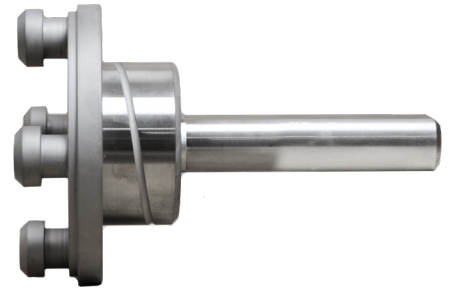

Part of drive hub - seen from different views
part number 30568

Wolfking® / CFS® / GEA® Pump Parts - Contiflow Pump (Stand Alone)

*Part of drive hub is only compatible with the Contiflow type pump "Stand alone".



Part of drive hub,
part number 5000035594 /35594

www.koncepttech.com

Koncept Tech ApS, Industrivej 6, DK-4200 Slagelse, Denmark, Phone: +45 70271410 E-mail: parts@koncepttech.com

All items, parts, and accessories listed on the website of Koncept Tech Aps, are manufactured by Koncept Tech Aps, or manufactured to Koncept Tech Aps, specifications. The names of the original equipment manufacturers referred to on this site, such as but not limited to: Camitech®, Handtmann®, K&G®, Krämer + Grebe®, CFS®, GEA®, Karl Schnell®, KS®, Laska®, Palmia®, Petsmo®, Seydelmann®, Simo®, Haarslev®, Weiler®, Mincemaster®, ANCO®, Cozzini®, The Middleby Corporation®, Wolfking®, Comvair®, Auto®, Beehive®, Yeldmaster®, Meatmaker®, Poss®, Townsend®, Lima® etc., are all registered trademarks of their respective companies. All original equipment manufacturer's names are listed as Camitech® type, Handtmann® type, K&G® type, Krämer + Grebe® type, CFS® type, Karl Schnell® type, KS® type, Laska® type, Palmia® type, Petsmo® type, Seydelmann® type, Simo® type, Haarslev® type, Weiler® type, Mincemaster® type, ANCO® type, Cozzini® type, Wolfking® type, Comvair® type, Auto® type, Beehive® type, Yeldmaster® type, Meatmaker® type, Poss® type, Townsend® type, Lima® type to indicate that these items are manufactured by Koncept Tech Aps, and not the original equipment manufacturers. Unless specifically stated otherwise, Koncept Tech Aps, has no association or affiliation with any entities/ companies listed.



Follow us on LinkedIn



Follow us on Facebook

Wolfling® / CFS® / GEA® Pump Parts - Contiflow Pump 250 & Vane Pump SF & DF (Cont.)



Suction Gate
part number 315657



Pump housing for CFD 16 m³
part number 5000032850 / 32850 , 5000035548 / 35548 , 50000317860 / 317680



Drive hub with pallet system



www.koncepttech.com

Koncept Tech ApS, Industrivej 6, DK-4200 Slagelse, Denmark, Phone: +45 70271410 E-mail: parts@koncepttech.com

All items, parts, and accessories listed on the website of Koncept Tech ApS, are manufactured by Koncept Tech ApS, or manufactured to Koncept Tech ApS, specifications. The names of the original equipment manufacturers referred to on this site, such as but not limited to: Camitech®, Handtmann®, K&G®, Krämer + Grebe®, CFS®, GEA®, Karl Schnell®, KS®, Laska®, Palmia®, Petsmo®, Seydelmann®, Simo®, Haarslev®, Weiler®, Mincemaster®, ANCO®, Cozzini®, The Middleby Corporation®, Wolfling®, Comvair®, Auto®, Beehive®, Yeldmaster®, Meatmaker®, Poss®, Townsend®, Lima® etc., are all registered trademarks of their respective companies. All original equipment manufacturer's names are listed as Camitech® type, Handtmann® type, K&G® type, Krämer + Grebe® type, CFS® type, Karl Schnell® type, KS® type, Laska® type, Palmia® type, Petsmo® type, Seydelmann® type, Simo® type, Haarslev® type, Weiler® type, Mincemaster® type, ANCO® type, Cozzini® type, Wolfling® type, Comvair® type, Auto® type, Beehive® type, Yeldmaster® type, Meatmaker® type, Poss® type, Townsend® type, Lima® type to indicate that these items are manufactured by Koncept Tech ApS, and not the original equipment manufacturers. Unless specifically stated otherwise, Koncept Tech ApS, has no association or affiliation with any entities/ companies listed.

Wolfling® / CFS® CAP 12 Pump

Machine Type	Description	Part Number
Wolfling® CAP 12 CFS® CAP 12	Drive hub 12m3 pump	5000407783 407783 5000039090 39090
Wolfling® CAP 12 CFS® CAP 12	Pumpring for 12m3 pump	5000360222 360222
Wolfling® CAP 12 CFS® CAP 12	Pumpring for 12m3 pump	5000360223 360223

Cozzini® Pump Parts - Type Vane Pump Parts

Exploded View of Cozzini® Type Vane Pump

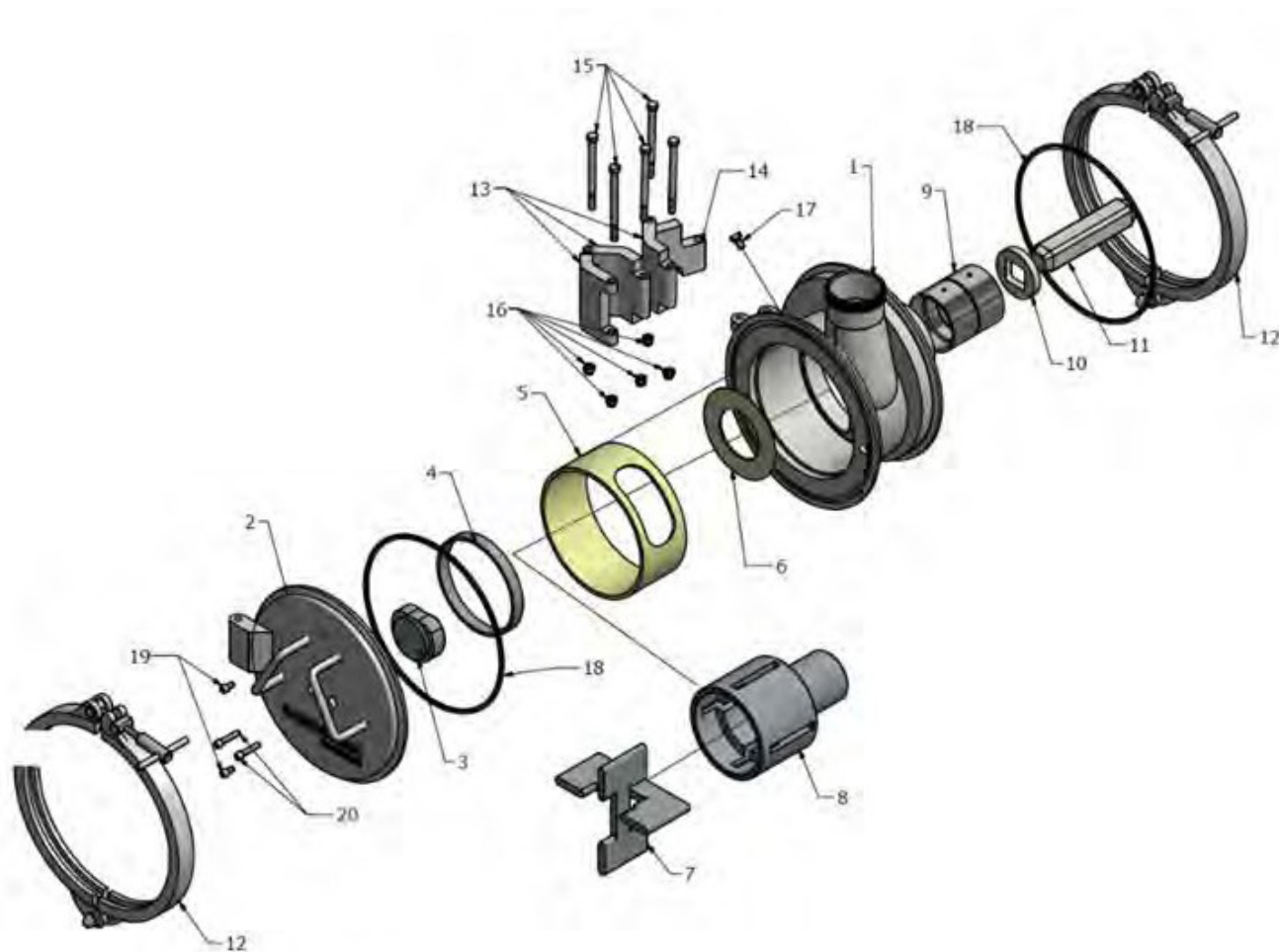











www.koncepttech.com

Koncept Tech ApS, Industrivej 6, DK-4200 Slagelse, Denmark, Phone: +45 70271410 E-mail: parts@koncepttech.com

All items, parts, and accessories listed on the website of Koncept Tech ApS, are manufactured by Koncept Tech ApS, or manufactured to Koncept Tech ApS, specifications. The names of the original equipment manufacturers referred to on this site, such as but not limited to: Camitech®, Handtmann®, K&G®, Krämer + Grebe®, CFS®, GEA®, Karl Schnell®, KS®, Laska®, Palmia®, Petsmo®, Seydelmann®, Simo®, Haarslev®, Weiler®, Mincemaster®, ANCO®, Cozzini®, The Middleby Corporation®, Wolkling®, Comvair®, Auto®, Beehive®, Yeldmaster®, Meatmaker®, Poss®, Townsend®, Lima® etc., are all registered trademarks of their respective companies. All original equipment manufacturer's names are listed as Camitech® type, Handtmann® type, K&G® type, Krämer + Grebe® type, CFS® type, Karl Schnell® type, KS® type, Laska® type, Palmia® type, Petsmo® type, Seydelmann® type, Simo® type, Haarslev® type, Weiler® type, Mincemaster® type, ANCO® type, Cozzini® type, Wolkling® type, Comvair® type, Auto® type, Beehive® type, Yeldmaster® type, Meatmaker® type, Poss® type, Townsend® type, Lima® type to indicate that these items are manufactured by Koncept Tech ApS, and not the original equipment manufacturers. Unless specifically stated otherwise, Koncept Tech ApS, has no association or affiliation with any entities/ companies listed.

Cozzini® Pump Parts - Type Vane Pump Parts (Cont.)

Parts List for Cozzini® 400 Type Vane Pump

Position No.	Description	Cozzini Part Number	
1	Housing pump	CVP3X002	
2	Pump cover	CVP3X021	
3	Cam	CVP3X006	
4	Cover bushing	CVP3X012	
5	Wear liner	CVP3X016	
6	Thrust washer	CVP3X028	
7	Vane set	CVP3X034	
8	Rotor	CVP3X037	
9	Bushing	07-001-0010	
10	Thrust washer	98-SPX9P113B	
11	Pump drive shaft	98-SPX9P111B	
12	Clamp	11-005-0111	
13	Hinge pump and cover	CVP3X022	
14	Adaptor hinge	CVP3X025	
15	Hexagon bolt -3 8-16 NC - 5 NC	FNC10142	
16	Hexagon nut nylon insert 3 8 - 16 NC	FNC04065	
17	Hexagon bolt -3 8-16 UNC - 0.75 NC	03-012-1759	
18	O-ring	12-001-0001	
19	Socket bolt -3 8-16 NC - .75 NC	03-012-1759	
20	Socket bolt -3 8-16 NC - 1.5 NC	03-012-1752	



Follow us on LinkedIn



Follow us on Facebook

Cozzini® Pump Parts - Type Vane Pump Parts (Cont.)

Full range of spare and wear parts for Cozzini® pumps – feel free to send us your parts number list plus the pump type/ model name in order for us to provide you with our quotation.



Cam heart shaped,
part number CVP3X006 ✓



Trust washer,
part number 98SRX9P113B ✓



Bushing,
part number 07-001-0010 ✓



Vane set,
part number CVP3X034 ✓



Pump rotor,
part number CVP3X037 ✓



Pump drive shaft,
part number 98-SPX9P111B ✓



Vane set,
part number CVP3X034 ✓



Trust washer,
part number CVP3X028 ✓



Wear liner,
part number CVP3X016 ✓

www.koncepttech.com

Koncept Tech ApS, Industrivej 6, DK-4200 Slagelse, Denmark, Phone: +45 70271410 E-mail: parts@koncepttech.com

All items, parts, and accessories listed on the website of Koncept Tech ApS, are manufactured by Koncept Tech ApS, or manufactured to Koncept Tech ApS, specifications. The names of the original equipment manufacturers referred to on this site, such as but not limited to: Camitech®, Handtmann®, K&G®, Krämer + Grebe®, CFS®, GEA®, Karl Schnell®, KS®, Laska®, Palmia®, Petsmo®, Seydelmann®, Simo®, Haarslev®, Weiler®, Mincemaster®, ANCO®, Cozzini®, The Middleby Corporation®, Wolkling®, Comvair®, Auto®, Beehive®, Yeldmaster®, Meatmaker®, Poss®, Townsend®, Lima® etc., are all registered trademarks of their respective companies. All original equipment manufacturer's names are listed as Camitech® type, Handtmann® type, K&G® type, Krämer + Grebe® type, CFS® type, Karl Schnell® type, KS® type, Laska® type, Palmia® type, Petsmo® type, Seydelmann® type, Simo® type, Haarslev® type, Weiler® type, Mincemaster® type, ANCO® type, Cozzini® type, Wolkling® type, Comvair® type, Auto® type, Beehive® type, Yeldmaster® type, Meatmaker® type, Poss® type, Townsend® type, Lima® type to indicate that these items are manufactured by Koncept Tech ApS, and not the original equipment manufacturers. Unless specifically stated otherwise, Koncept Tech ApS, has no association or affiliation with any entities/ companies listed.



Follow us on LinkedIn



Follow us on Facebook

Cozzini® Pump Parts - Type Vane Pump Parts (Cont.)



Example of Cozzini® type pump



For complete new scansteel foodtech pumps:
please ask scansteel foodtech for a quote for our scansteel foodtech pump

Highlighted blue areas show geographic location of Koncept Tech agents and distributors

SPREAD OVER 6 CONTINENTS

ACTIVE IN 24 COUNTRIES

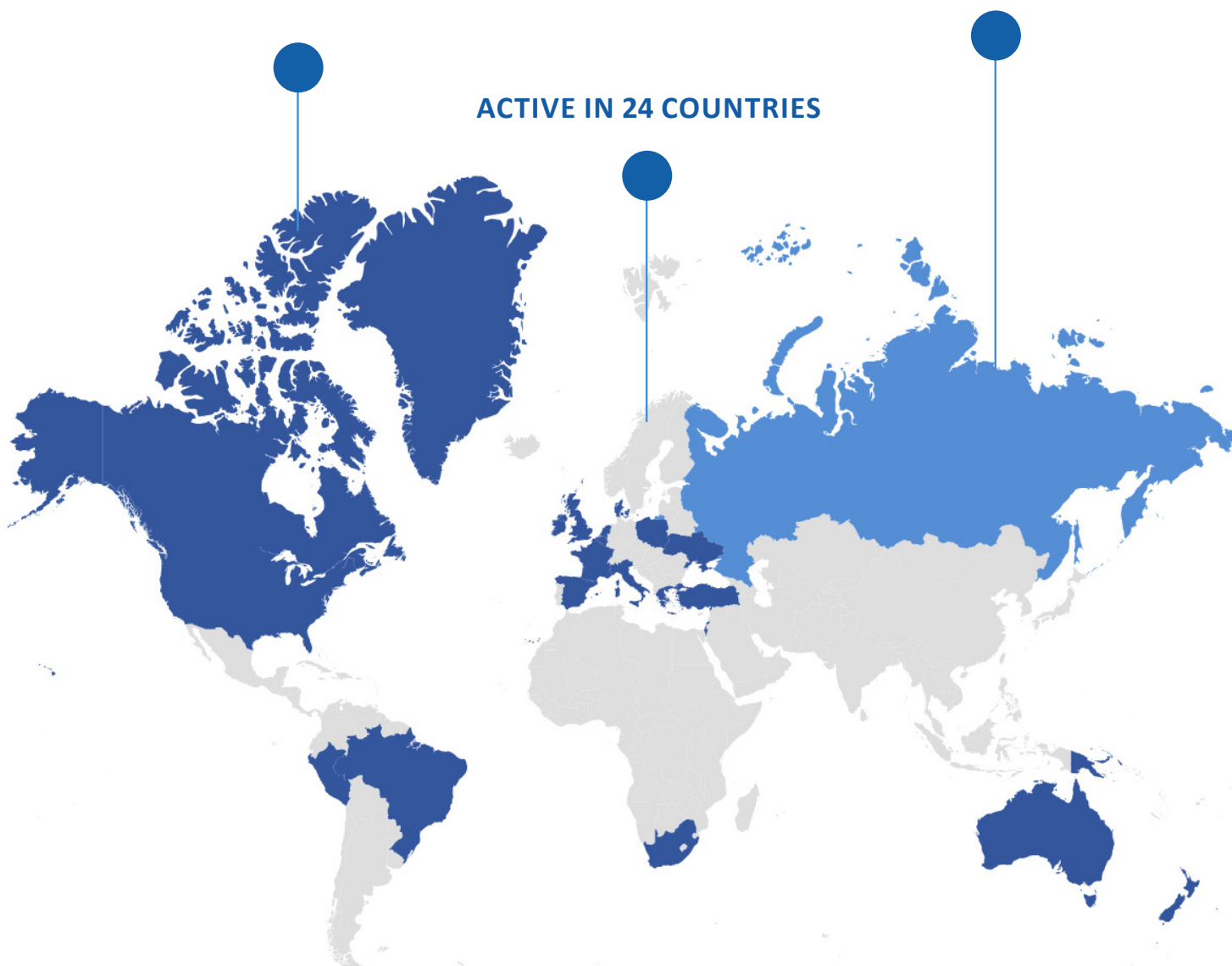

Find your local
Koncept Tech contact

Koncept Tech ApS, Industrivej 6, DK-4200 Slagelse, Denmark, Phone: +45 70271410 E-mail: parts@koncepttech.com



Follow us on LinkedIn



Follow us on Facebook

Koncept Tech

Parts Portal



Contact us today!



Helle Friis Olsen
Sales and Global Agent Support
Mobile: +45 2128 9785



Maria Ravnskjær
Sales and Global Agent Support
Mobile: +45 2917 1424

www.koncepttech.com

Koncept Tech ApS, Industrivej 6, DK-4200 Slagelse, Denmark, Phone: +45 70271410 E-mail: parts@koncepttech.com

All items, parts, and accessories listed on the website of Koncept Tech ApS, are manufactured by Koncept Tech ApS, or manufactured to Koncept Tech ApS, specifications. The names of the original equipment manufacturers referred to on this site, such as but not limited to: Camitech®, Handtmann®, K&G®, Krämer + Grebe®, CFS®, GEA®, Karl Schnell®, KS®, Laska®, Palmia®, Petsmo®, Seydelmann®, Simo®, Haarslev®, Weiler®, Mincemaster®, ANCO®, Cozzini®, The Middleby Corporation®, Wolkling®, Convair®, Auto®, Beehive®, Yeldmaster®, Meatmaker®, Poss®, Townsend®, Lima®, etc., are all registered trademarks of their respective companies. All original equipment manufacturer's names are listed as Camitech® type, Handtmann® type, K&G® type, Krämer + Grebe® type, CFS® type, Karl Schnell® type, KS® type, Laska® type, Palmia® type, Petsmo® type, Seydelmann® type, Simo® type, Haarslev® type, Weiler® type, Mincemaster® type, ANCO® type, Cozzini® type, Wolkling® type, Convair® type, Auto® type, Beehive® type, Yeldmaster® type, Meatmaker® type, Poss® type, Townsend® type, Lima® type to indicate that these items are manufactured by Koncept Tech ApS, and not the original equipment manufacturers. Unless specifically stated otherwise, Koncept Tech ApS, has no association or affiliation with any entities/ companies listed.



Follow us on LinkedIn



Follow us on Facebook

Koncept Tech

Parts Portal

Notes

www.koncepttech.com

Koncept Tech ApS, Industrivej 6, DK-4200 Slagelse, Denmark, Phone: +45 70271410 E-mail: parts@koncepttech.com

All items, parts, and accessories listed on the website of Koncept Tech ApS, are manufactured by Koncept Tech ApS, or manufactured to Koncept Tech ApS, specifications. The names of the original equipment manufacturers referred to on this site, such as but not limited to: Camitech®, Handtmann®, K&G®, Krämer + Grebe®, CFS®, GEA®, Karl Schnell®, KS®, Laska®, Palmia®, Petsmo®, Seydelmann®, Simo®, Haarslev®, Weiler®, Mincemaster®, ANCO®, Cozzini®, The Middleby Corporation®, Wolfking®, Comvair®, Auto®, Beehive®, Yeldmaster®, Meatmaker®, Poss®, Townsend®, Lima® etc., are all registered trademarks of their respective companies. All original equipment manufacturer's names are listed as Camitech® type, Handtmann® type, K&G® type, Krämer + Grebe® type, CFS® type, Karl Schnell® type, KS® type, Laska® type, Palmia® type, Petsmo® type, Seydelmann® type, Simo® type, Haarslev® type, Weiler® type, Mincemaster® type, ANCO® type, Cozzini® type, Wolfking® type, Comvair® type, Auto® type, Beehive® type, Yeldmaster® type, Meatmaker® type, Poss® type, Townsend® type, Lima® type to indicate that these items are manufactured by Koncept Tech ApS, and not the original equipment manufacturers. Unless specifically stated otherwise, Koncept Tech ApS, has no association or affiliation with any entities/ companies listed.



Follow us on LinkedIn



Follow us on Facebook

Koncept Tech

Parts Portal

Notes

www.koncepttech.com

Koncept Tech ApS, Industrivej 6, DK-4200 Slagelse, Denmark, Phone: +45 70271410 E-mail: parts@koncepttech.com

All items, parts, and accessories listed on the website of Koncept Tech ApS, are manufactured by Koncept Tech ApS, or manufactured to Koncept Tech ApS, specifications. The names of the original equipment manufacturers referred to on this site, such as but not limited to: Camitech®, Handtmann®, K&G®, Krämer + Grebe®, CFS®, GEA®, Karl Schnell®, KS®, Laska®, Palmia®, Petsmo®, Seydelmann®, Simo®, Haarslev®, Weiler®, Mincemaster®, ANCO®, Cozzini®, The Middleby Corporation®, Wolfking®, Comvair®, Auto®, Beehive®, Yeldmaster®, Meatmaker®, Poss®, Townsend®, Lima® etc., are all registered trademarks of their respective companies. All original equipment manufacturer's names are listed as Camitech® type, Handtmann® type, K&G® type, Krämer + Grebe® type, CFS® type, Karl Schnell® type, KS® type, Laska® type, Palmia® type, Petsmo® type, Seydelmann® type, Simo® type, Haarslev® type, Weiler® type, Mincemaster® type, ANCO® type, Cozzini® type, Wolfking® type, Comvair® type, Auto® type, Beehive® type, Yeldmaster® type, Meatmaker® type, Poss® type, Townsend® type, Lima® type to indicate that these items are manufactured by Koncept Tech ApS, and not the original equipment manufacturers. Unless specifically stated otherwise, Koncept Tech ApS, has no association or affiliation with any entities/ companies listed.

Koncept Tech ApS Member of scansteel foodtech Group

Koncept Tech ApS member of scansteel foodtech group



10,450 m² factory in Denmark

Headquarters of:

- **Koncept Tech ApS**
- **scansteel foodtech A/S**

www.koncepttech.com

Koncept Tech ApS, Industrivej 6, DK-4200 Slagelse, Denmark, Phone: +45 70271410 E-mail: parts@koncepttech.com

All items, parts, and accessories listed on the website of Koncept Tech ApS, are manufactured by Koncept Tech ApS, or manufactured to Koncept Tech ApS, specifications. The names of the original equipment manufacturers referred to on this site, such as but not limited to: Camiltech®, Handtmann®, K&G®, Krämer + Grebe®, CFS®, GEA®, Karl Schnell®, KS®, Laska®, Palmia®, Petsmo®, Seydelmann®, Simo®, Haarslev®, Weiler®, Mincemaster®, ANCO®, Cozzini®, The Middleby Corporation®, Wolkling®, Comvair®, Auto®, Beehive®, Yeldmaster®, Meatmaker®, Poss®, Townsend®, Lima® etc., are all registered trademarks of their respective companies. All original equipment manufacturer's names are listed as Camiltech® type, Handtmann® type, K&G® type, Krämer + Grebe® type, CFS® type, Karl Schnell® type, KS® type, Laska® type, Palmia® type, Petsmo® type, Seydelmann® type, Simo® type, Haarslev® type, Weiler® type, Mincemaster® type, ANCO® type, Cozzini® type, Wolkling® type, Comvair® type, Auto® type, Beehive® type, Yeldmaster® type, Meatmaker® type, Poss® type, Townsend® type, Lima® type to indicate that these items are manufactured by Koncept Tech ApS, and not the original equipment manufacturers. Unless specifically stated otherwise, Koncept Tech ApS, has no association or affiliation with any entities/ companies listed.